

# Drawings

## ROTAMASS Total Insight Coriolis Mass Flow and Density Meter Supreme



SD 01U10B02-00EN-R



## Table of contents

<b>1</b>	<b>Process connections, dimensions and weights of sensor .....</b>	<b>3</b>
<b>2</b>	<b>Transmitter dimensions and weights .....</b>	<b>22</b>
<b>3</b>	<b>Wiring .....</b>	<b>24</b>
3.1	Terminal configuration diagrams .....	24
3.1.1	Terminal for connection between sensor and transmitter .....	24
3.1.2	Terminal for I/O outputs and power supply .....	24
<b>4</b>	<b>Connecting cable dimensions and weights.....</b>	<b>25</b>
4.1	Standard cable (option /L_ _ _ without option /LAC) .....	25
4.2	Steel armored cable (option /L_ _ _ with option /LAC) .....	26
4.3	Fire retardant cable (option /Y_ _ _) .....	27
<b>5</b>	<b>Japan Ex cable gland dimensions (option /V5_ ).....</b>	<b>28</b>

# 1 Process connections, dimensions and weights of sensor

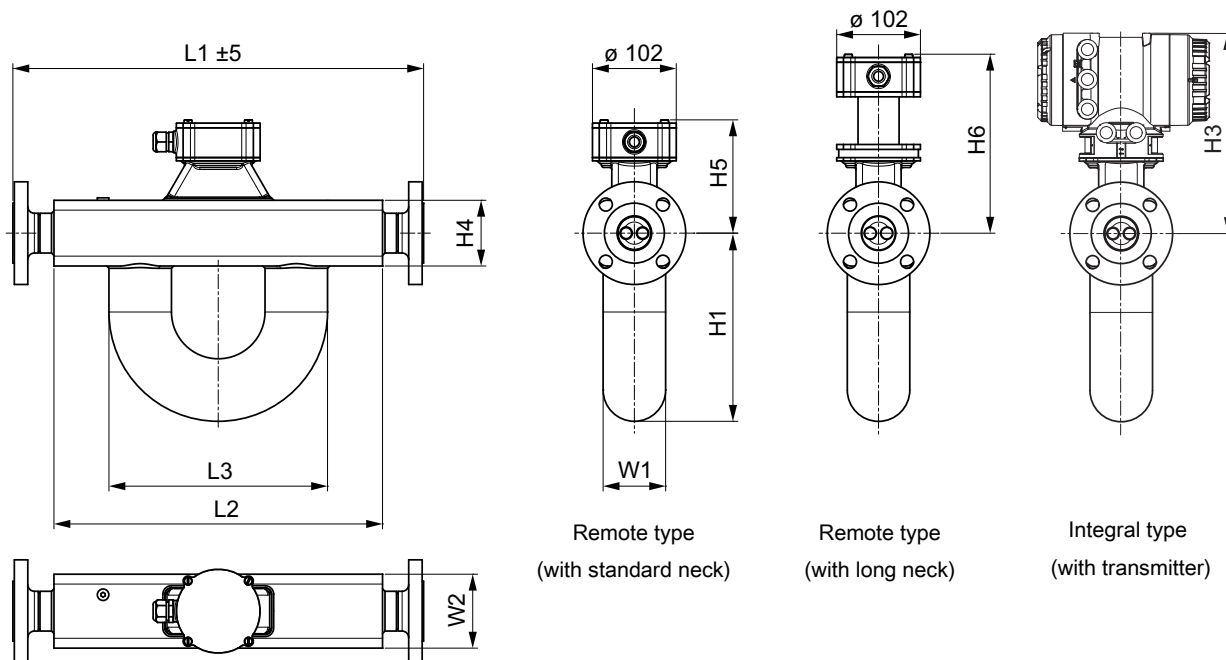

Fig. 1: Dimensions in mm

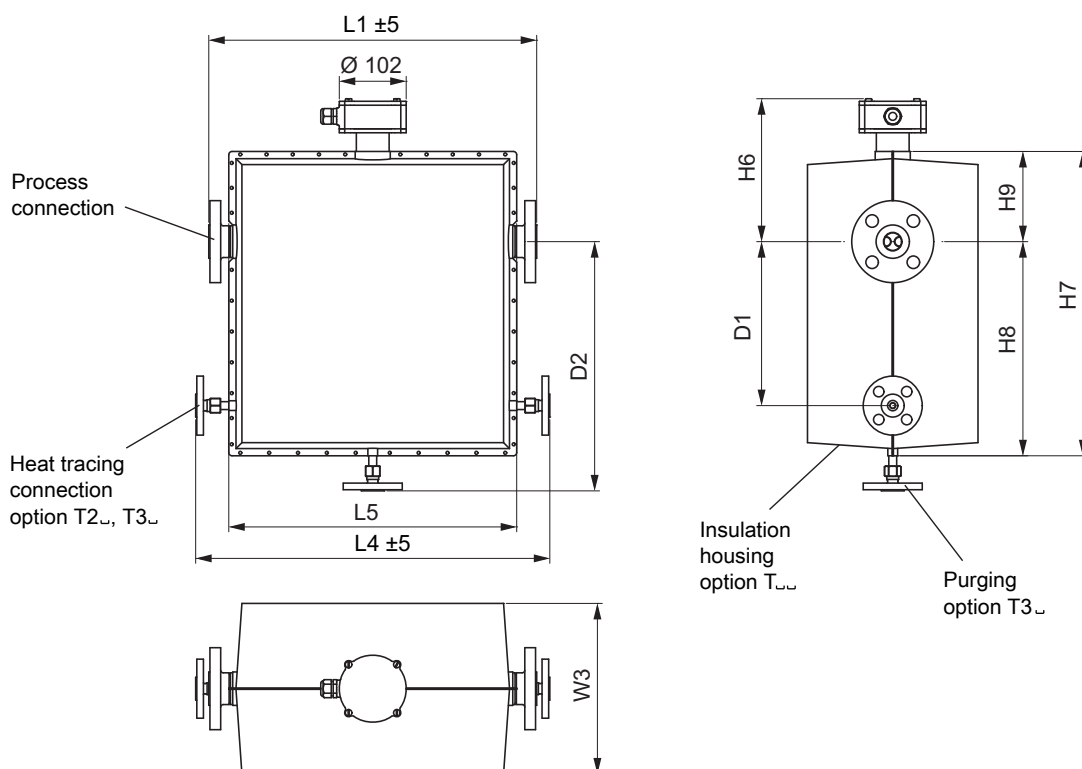

Fig. 2: Dimensions in mm: version with insulation housing

Tab. 1: Dimensions without length L1

Meter size	L2	L3	L4	L5	W1	W2	W3	D1	D2
	in mm (inch)								
Supreme 34	272 (10.7)	212 (8.3)	420 (16.5)	310 (12.2)	60 (2.4)	80 (3.1)	240 (9.4)	200 (7.9)	330 (13)
Supreme 36	400 (15.7)	266 (10.5)	540 (21.3)	439 (17.3)	76 (3)	90 (3.5)	260 (10.2)	250 (9.8)	380 (15)
Supreme 38	490 (19.3)	267 (10.5)	640 (25.2)	530 (20.9)	89 (3.5)	110 (4.3)	260 (10.2)	250 (9.8)	430 (16.9)
Supreme 39	850 (33.5)	379 (14.9)	1000 (39.4)	894 (35.2)	129 (5.1)	160 (6.3)	302 (11.9)	350 (13.8)	545 (21.5)

Tab. 2: Dimensions without length L1

Meter size	H1	H3	H4	H5	H6	H7	H8	H9
	in mm (inch)							
Supreme 34	177 (7)	267 (10.5)	80 (3.1)	138 (5.4)	218 (8.6)	411 (16.2)	273 (10.7)	138 (5.4)
Supreme 36	230 (9.1)	267 (10.5)	80 (3.1)	138 (5.4)	218 (8.6)	464 (18.3)	326 (12.8)	138 (5.4)
Supreme 38	268 (10.6)	277 (10.9)	100 (3.9)	148 (5.8)	228 (9)	524 (20.6)	376 (14.8)	148 (5.8)
Supreme 39	370 (14.6)	294.5 (11.6)	135 (5.3)	165 (6.5)	246 (9.7)	668 (26.3)	503 (19.8)	165 (6.5)

### Overall length L1 and weight

The overall length of the sensor depends on the selected process connection (type and size of flange). The following tables list the overall length and weight (without insulation or heat tracing and without customized installation length options) as functions of the individual process connection.

The weights in the tables are for the remote type with standard neck. Additional weight for the remote type with long neck: 1 kg (2.2 lb). Additional weight for the integral type: up to 3.2 kg (7.1 lb).

Process connections compatible to ASME B16.5 (AISI 316/ AISI 316L dual certified)

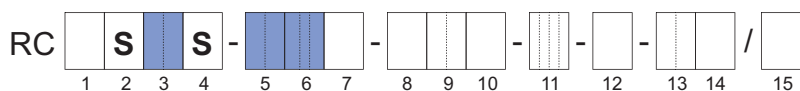

Tab. 3: Overall length L1 and weight of sensor (process connections: ASME, wetted parts: stainless steel)

Process connections	Model code pos.5+6		Supreme 34		Supreme 36		Supreme 38		Supreme 39	
	5	6	L1 in mm (inch)	Weight in kg (lb)	L1 in mm (inch)	Weight in kg (lb)	L1 in mm (inch)	Weight in kg (lb)	L1 in mm (inch)	Weight in kg (lb)
ASME ½" class 150, raised face (RF)	15	BA1	370 (14.6)	10 (22)	-	-	-	-	-	-
ASME ½" class 300, raised face (RF)		BA2	370 (14.6)	10.4 (23)	-	-	-	-	-	-
ASME ½" class 600, raised face (RF)		BA4	380 (15)	10.6 (23)	-	-	-	-	-	-
ASME ½" class 600, ring joint (RJ)		CA4	380 (15)	10.6 (23)	-	-	-	-	-	-
ASME 1" class 150, raised face (RF)	25	BA1	370 (14.6)	10.8 (24)	500 (19.7)	14.8 (33)	-	-	-	-
ASME 1" class 300, raised face (RF)		BA2	370 (14.6)	11.8 (26)	500 (19.7)	15.8 (35)	-	-	-	-
ASME 1" class 600, raised face (RF)		BA4	390 (15.4)	12.2 (27)	520 (20.5)	16.2 (36)	-	-	-	-
ASME 1" class 600, ring joint (RJ)		CA4	390 (15.4)	12.4 (27)	520 (20.5)	16.2 (36)	-	-	-	-
ASME 1½" class 150, raised face (RF)	40	BA1	380 (15)	11.8 (26)	500 (19.7)	15.8 (35)	600 (23.6)	25 (55)	-	-
ASME 1½" class 300, raised face (RF)		BA2	380 (15)	14.2 (31)	510 (20.1)	18.2 (40)	600 (23.6)	27.2 (60)	-	-
ASME 1½" class 600, raised face (RF)		BA4	400 (15.7)	15.4 (34)	530 (20.9)	19.2 (42)	620 (24.4)	28.2 (62)	-	-
ASME 1½" class 600, ring joint (RJ)		CA4	400 (15.7)	15.4 (34)	530 (20.9)	19.4 (43)	620 (24.4)	28.2 (62)	-	-
ASME 2" class 150, raised face (RF)	50	BA1	-	-	510 (20.1)	17.4 (38)	600 (23.6)	26.4 (58)	-	-
ASME 2" class 300, raised face (RF)		BA2	-	-	510 (20.1)	19 (42)	600 (23.6)	28 (62)	-	-
ASME 2" class 600, raised face (RF)		BA4	-	-	540 (21.3)	20.8 (46)	630 (24.8)	29.8 (66)	-	-
ASME 2" class 600, ring joint (RJ)		CA4	-	-	540 (21.3)	21.2 (47)	630 (24.8)	29.8 (66)	-	-
ASME 2½" class 150, raised face (RF)	65	BA1	-	-	-	-	610 (24)	29.6 (65)	-	-
ASME 2½" class 300, raised face (RF)		BA2	-	-	-	-	610 (24)	31 (68)	-	-
ASME 2½" class 600, raised face (RF)		BA4	-	-	-	-	640 (25.2)	33.4 (74)	-	-
ASME 2½" class 600, ring joint (RJ)		CA4	-	-	-	-	640 (25.2)	34.4 (76)	-	-

Process connections	Model code pos.5+6		Supreme 34		Supreme 36		Supreme 38		Supreme 39	
	5	6	L1 in mm (inch)	Weight in kg (lb)	L1 in mm (inch)	Weight in kg (lb)	L1 in mm (inch)	Weight in kg (lb)	L1 in mm (inch)	Weight in kg (lb)
ASME 3" class 150, raised face (RF)	80	BA1	–	–	–	–	610 (24)	30.6 (67)	1000 (39.4)	60.2 (133)
ASME 3" class 300, raised face (RF)		BA2	–	–	–	–	620 (24.4)	34.6 (76)	1000 (39.4)	63.4 (140)
ASME 3" class 600, raised face (RF)		BA4	–	–	–	–	640 (25.2)	38 (84)	1000 (39.4)	65.8 (145)
ASME 3" class 600, ring joint (RJ)		CA4	–	–	–	–	640 (25.2)	38.6 (85)	1000 (39.4)	65.8 (145)
ASME 4" class 150, raised face (RF)	1H	BA1	–	–	–	–	–	–	1000 (39.4)	64 (141)
ASME 4" class 300, raised face (RF)		BA2	–	–	–	–	–	–	1000 (39.4)	71.4 (157)
ASME 4" class 600, raised face (RF)		BA4	–	–	–	–	–	–	1030 (40.6)	82.6 (182)
ASME 4" class 600, ring joint (RJ)		CA4	–	–	–	–	–	–	1030 (40.6)	82.8 (183)
ASME 5" class 150, raised face (RF)	1Q	BA1	–	–	–	–	–	–	1000 (39.4)	66 (146)
ASME 5" class 300, raised face (RF)		BA2	–	–	–	–	–	–	1000 (39.4)	78.4 (173)
ASME 5" class 600, raised face (RF)		BA4	–	–	–	–	–	–	1040 (40.9)	102.8 (227)
ASME 5" class 600, ring joint (RJ)		CA4	–	–	–	–	–	–	1040 (40.9)	103.6 (228)

Meaning of "–": not available

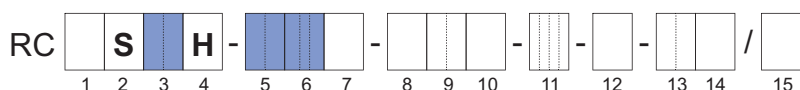

Tab. 4: Overall length L1 and weight of sensor (process connections: ASME, wetted parts: Ni alloy C-22/2.4602)

Process connections	Model code pos.		Supreme 34		Supreme 36		Supreme 38		Supreme 39	
	5	6	L1 in mm (inch)	Weight in kg (lb)	L1 in mm (inch)	Weight in kg (lb)	L1 in mm (inch)	Weight in kg (lb)	L1 in mm (inch)	Weight in kg (lb)
ASME 1" class 150, raised face (RF)	25	BA1	390 (15.4)	11.4 (25)	-	-	-	-	-	-
ASME 1" class 300, raised face (RF)		BA2	390 (15.4)	12.6 (28)	-	-	-	-	-	-
ASME 1" class 600, raised face (RF)		BA4	390 (15.4)	12.4 (27)	-	-	-	-	-	-
ASME 1½" class 150, raised face (RF)	40	BA1	390 (15.4)	12.6 (28)	520 (20.5)	16.5 (36)	-	-	-	-
ASME 1½" class 300, raised face (RF)		BA2	390 (15.4)	15.4 (34)	520 (20.5)	19.1 (42)	-	-	-	-
ASME 1½" class 600, raised face (RF)		BA4	400 (15.7)	15.6 (34)	530 (20.9)	19.6 (43)	-	-	-	-
ASME 2" class 150, raised face (RF)	50	BA1	390 (15.4)	14.8 (33)	520 (20.5)	18.5 (41)	620 (24.4)	27.3 (60)	-	-
ASME 2" class 300, raised face (RF)		BA2	390 (15.4)	16 (35)	520 (20.5)	20.5 (45)	620 (24.4)	29.1 (64)	-	-
ASME 2" class 600, raised face (RF)		BA4	410 (16.1)	17.6 (39)	540 (21.3)	21.6 (45)	630 (24.8)	29.7 (66)	-	-
ASME 2½" class 150, raised face (RF)	65	BA1	-	-	-	-	620 (24.4)	30.9 (68)	-	-
ASME 2½" class 300, raised face (RF)		BA2	-	-	-	-	620 (24.4)	32.5 (72)	-	-
ASME 2½" class 600, raised face (RF)		BA4	-	-	-	-	640 (25.2)	33.9 (75)	-	-
ASME 3" class 150, raised face (RF)	80	BA1	-	-	-	-	620 (24.4)	32.8 (72)	1020 (40.2)	61.1 (135)
ASME 3" class 300, raised face (RF)		BA2	-	-	-	-	620 (24.4)	36.6 (81)	1020 (40.2)	64.5 (142)
ASME 3" class 600, raised face (RF)		BA4	-	-	-	-	640 (25.2)	38.9 (86)	1020 (40.2)	65.9 (145)
ASME 4" class 150, raised face (RF)	1H	BA1	-	-	-	-	-	-	1020 (40.2)	66.2 (146)
ASME 4" class 300, raised face (RF)		BA2	-	-	-	-	-	-	1020 (40.2)	74.8 (165)
ASME 4" class 600, raised face (RF)		BA4	-	-	-	-	-	-	1030 (40.6)	84.9 (187)
ASME 5" class 150, raised face (RF)	1Q	BA1	-	-	-	-	-	-	1020 (40.2)	72.7 (160)
ASME 5" class 300, raised face (RF)		BA2	-	-	-	-	-	-	1020 (40.2)	83.9 (185)
ASME 5" class 600, raised face (RF)		BA4	-	-	-	-	-	-	1040 (40.9)	108.2 (238)

Meaning of "-": not available

### Process connections compatible to EN 1092-1 (1.4404/ AISI 316 L)

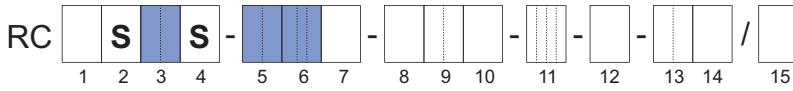

Tab. 5: Overall length L1 and weight of sensor (process connections: EN, wetted parts: stainless steel)

Process connections	Model code		Supreme 34		Supreme 36		Supreme 38		Supreme 39	
	pos.		L1 in mm (inch)	Weight in kg (lb)	L1 in mm (inch)	Weight in kg (lb)	L1 in mm (inch)	Weight in kg (lb)	L1 in mm (inch)	Weight in kg (lb)
	5	6								
EN DN15 PN40, type B1, raised face (RF)	15	BD4	370 (14.6)	10.6 (23)	-	-	-	-	-	-
EN DN15 PN40, type D, with groove		GD4	370 (14.6)	10.4 (23)	-	-	-	-	-	-
EN DN15 PN40, type E, with spigot		ED4	370 (14.6)	10.4 (23)	-	-	-	-	-	-
EN DN15 PN40, type F, with recess		FD4	370 (14.6)	10.4 (23)	-	-	-	-	-	-
EN DN15 PN100, type B1, raised face (RF)		BD6	380 (15)	11.4 (25)	-	-	-	-	-	-
EN DN15 PN100, type D, with groove		GD6	380 (15)	17.4 (38)	-	-	-	-	-	-
EN DN15 PN100, type E, with spigot		ED6	380 (15)	11.2 (25)	-	-	-	-	-	-
EN DN15 PN100, type F, with recess		FD6	380 (15)	11.4 (25)	-	-	-	-	-	-
EN DN25 PN40, type B1, raised face (RF)	25	BD4	370 (14.6)	11.6 (26)	500 (19.7)	15.6 (34)	-	-	-	-
EN DN25 PN40, type D, with groove		GD4	370 (14.6)	11.4 (25)	500 (19.7)	15.4 (34)	-	-	-	-
EN DN25 PN40, type E, with spigot		ED4	370 (14.6)	11.2 (25)	500 (19.7)	15.2 (34)	-	-	-	-
EN DN25 PN40, type F, with recess		FD4	370 (14.6)	11.4 (25)	500 (19.7)	15.4 (34)	-	-	-	-
EN DN25 PN100, type B1, raised face (RF)		BD6	390 (15.4)	14 (31)	520 (20.5)	18.2 (40)	-	-	-	-
EN DN25 PN100, type D, with groove		GD6	390 (15.4)	14 (31)	520 (20.5)	18 (40)	-	-	-	-
EN DN25 PN100, type E, with spigot		ED6	390 (15.4)	13.6 (30)	520 (20.5)	17.6 (39)	-	-	-	-
EN DN25 PN100, type F, with recess		FD6	390 (15.4)	14 (31)	520 (20.5)	18 (40)	-	-	-	-

Process connections	Model code pos.		Supreme 34		Supreme 36		Supreme 38		Supreme 39	
			L1	Weight	L1	Weight	L1	Weight	L1	Weight
	5	6	in mm (inch)	in kg (lb)	in mm (inch)	in kg (lb)	in mm (inch)	in kg (lb)	in mm (inch)	in kg (lb)
EN DN40 PN40, type B1, raised face (RF)	40	BD4	370 (14.6)	13 (29)	500 (19.7)	17 (37)	600 (23.6)	26.2 (58)	–	–
EN DN40 PN40, type D, with groove		GD4	370 (14.6)	13 (29)	500 (19.7)	17 (37)	600 (23.6)	26 (57)	–	–
EN DN40 PN40, type E, with spigot		ED4	370 (14.6)	12.6 (28)	500 (19.7)	16.6 (37)	600 (23.6)	25.8 (57)	–	–
EN DN40 PN40, type F, with recess		FD4	370 (14.6)	12.8 (28)	500 (19.7)	16.8 (37)	600 (23.6)	26 (57)	–	–
EN DN40 PN100, type B1, raised face (RF)		BD6	450 (17.7)	17.6 (39)	560 (22)	21.2 (47)	620 (24.4)	29.8 (66)	–	–
EN DN40 PN100, type D, with groove		GD6	450 (17.7)	17.4 (38)	560 (22)	21.2 (47)	620 (24.4)	29.6 (65)	–	–
EN DN40 PN100, type E, with spigot		ED6	450 (17.7)	17 (37)	560 (22)	20.8 (46)	620 (24.4)	29.2 (64)	–	–
EN DN40 PN100, type F, with recess		FD6	450 (17.7)	17.4 (38)	560 (22)	21 (46)	620 (24.4)	29.6 (65)	–	–
EN DN50 PN40, type B1, raised face (RF)	50	BD4	–	–	500 (19.7)	18.4 (41)	600 (23.6)	27.4 (60)	–	–
EN DN50 PN40, type D, with groove		GD4	–	–	500 (19.7)	18.2 (40)	600 (23.6)	27.4 (60)	–	–
EN DN50 PN40, type E, with spigot		ED4	–	–	500 (19.7)	18 (40)	600 (23.6)	27 (60)	–	–
EN DN50 PN40, type F, with recess		FD4	–	–	500 (19.7)	18.2 (40)	600 (23.6)	27.2 (60)	–	–
EN DN50 PN63, type B1, raised face (RF)		BD5	–	–	520 (20.5)	21.6 (48)	620 (24.4)	30.6 (67)	–	–
EN DN50 PN63, type D, with groove		GD5	–	–	520 (20.5)	21.4 (47)	620 (24.4)	30.4 (67)	–	–
EN DN50 PN63, type E, with spigot		ED5	–	–	520 (20.5)	21 (46)	620 (24.4)	30 (66)	–	–
EN DN50 PN63, type F, with recess		FD5	–	–	520 (20.5)	21.2 (47)	620 (24.4)	30.2 (67)	–	–
EN DN50 PN100, type B1, raised face (RF)		BD6	–	–	590 (23.2)	25.2 (56)	660 (26)	33.6 (74)	–	–
EN DN50 PN100, type D, with groove		GD6	–	–	590 (23.2)	25 (55)	660 (26)	33.4 (74)	–	–
EN DN50 PN100, type E, with spigot		ED6	–	–	590 (23.2)	24.4 (54)	660 (26)	33 (73)	–	–
EN DN50 PN100, type F, with recess		FD6	–	–	590 (23.2)	24.8 (55)	660 (26)	33.4 (74)	–	–

Process connections	Model code pos.		Supreme 34		Supreme 36		Supreme 38		Supreme 39		
	5	6	L1	Weight	L1	Weight	L1	Weight	L1	Weight	
			in mm (inch)	in kg (lb)	in mm (inch)	in kg (lb)	in mm (inch)	in kg (lb)	in mm (inch)	in kg (lb)	
EN DN80 PN40, type B1, raised face (RF)	80	BD4	–	–	–	–	610 (24)	31 (68)	1000 (39.4)	60.4 (133)	
EN DN80 PN40, type D, with groove		GD4	–	–	–	–	610 (24)	30.8 (68)	1000 (39.4)	60.2 (133)	
EN DN80 PN40, type E, with spigot		ED4	–	–	–	–	610 (24)	30.4 (67)	1000 (39.4)	59.8 (132)	
EN DN80 PN40, type F, with recess		FD4	–	–	–	–	610 (24)	30.6 (67)	1000 (39.4)	60 (132)	
EN DN80 PN63, type B1, raised face (RF)		BD5	–	–	–	–	620 (24.4)	34.4 (76)	1000 (39.4)	63.4 (140)	
EN DN80 PN63, type D, with groove		GD5	–	–	–	–	620 (24.4)	34.2 (75)	1000 (39.4)	63.2 (139)	
EN DN80 PN63, type E, with spigot		ED5	–	–	–	–	620 (24.4)	33.6 (74)	1000 (39.4)	62.8 (138)	
EN DN80 PN63, type F, with recess		FD5	–	–	–	–	620 (24.4)	33.8 (75)	1000 (39.4)	63 (139)	
EN DN80 PN100, type B1, raised face (RF)		BD6	–	–	–	–	730 (28.7)	41.8 (92)	1000 (39.4)	67.2 (148)	
EN DN80 PN100, type D, with groove		GD6	–	–	–	–	730 (28.7)	41.6 (92)	1000 (39.4)	67 (148)	
EN DN80 PN100, type E, with spigot		ED6	–	–	–	–	730 (28.7)	41 (90)	1000 (39.4)	66.4 (146)	
EN DN80 PN100, type F, with recess		FD6	–	–	–	–	730 (28.7)	41.4 (91)	1000 (39.4)	66.6 (147)	
EN DN100 PN40, type B1, raised face (RF)		1H	BD4	–	–	–	–	–	–	1000 (39.4)	63.6 (140)
EN DN100 PN40, type D, with groove			GD4	–	–	–	–	–	–	1000 (39.4)	63.2 (139)
EN DN100 PN40, type E, with spigot	ED4		–	–	–	–	–	–	1000 (39.4)	62.4 (138)	
EN DN100 PN40, type F, with recess	FD4		–	–	–	–	–	–	1000 (39.4)	62.6 (138)	
EN DN100 PN63, type B1, raised face (RF)	BD5		–	–	–	–	–	–	1000 (39.4)	68 (150)	
EN DN100 PN63, type D, with groove	GD5		–	–	–	–	–	–	1000 (39.4)	67.8 (149)	
EN DN100 PN63, type E, with spigot	ED5		–	–	–	–	–	–	1000 (39.4)	67 (148)	
EN DN100 PN63, type F, with recess	FD5		–	–	–	–	–	–	1000 (39.4)	67.4 (149)	
EN DN100 PN100, type B1, raised face (RF)	BD6		–	–	–	–	–	–	1050 (41.3)	76.6 (169)	
EN DN100 PN100, type D, with groove	GD6		–	–	–	–	–	–	1050 (41.3)	76.2 (168)	
EN DN100 PN100, type E, with spigot	ED6		–	–	–	–	–	–	1050 (41.3)	75.4 (166)	
EN DN100 PN100, type F, with recess	FD6		–	–	–	–	–	–	1050 (41.3)	75.8 (167)	

Process connections	Model code pos.		Supreme 34		Supreme 36		Supreme 38		Supreme 39	
	5	6	L1	Weight	L1	Weight	L1	Weight	L1	Weight
			in mm (inch)	in kg (lb)	in mm (inch)	in kg (lb)	in mm (inch)	in kg (lb)	in mm (inch)	in kg (lb)
EN DN125 PN40, type B1, raised face (RF)	1Q	BD4	–	–	–	–	–	–	1000 (39.4)	67.6 (149)
EN DN125 PN40, type D, with groove		GD4	–	–	–	–	–	–	1000 (39.4)	67.2 (148)
EN DN125 PN40, type E, with spigot		ED4	–	–	–	–	–	–	1000 (39.4)	66.4 (146)
EN DN125 PN40, type F, with recess		FD4	–	–	–	–	–	–	1000 (39.4)	66.6 (147)
EN DN125 PN63, type B1, raised face (RF)		BD5	–	–	–	–	–	–	1000 (39.4)	77.8 (172)
EN DN125 PN63, type D, with groove		GD5	–	–	–	–	–	–	1000 (39.4)	77.4 (171)
EN DN125 PN63, type E, with spigot		ED5	–	–	–	–	–	–	1000 (39.4)	76.4 (168)
EN DN125 PN63, type F, with recess		FD5	–	–	–	–	–	–	1000 (39.4)	76.8 (169)
EN DN125 PN100, type B1, raised face (RF)		BD6	–	–	–	–	–	–	1100 (43.3)	93.2 (205)
EN DN125 PN100, type D, with groove		GD6	–	–	–	–	–	–	1100 (43.3)	92.8 (205)
EN DN125 PN100, type E, with spigot		ED6	–	–	–	–	–	–	1100 (43.3)	91.4 (202)
EN DN125 PN100, type F, with recess		FD6	–	–	–	–	–	–	1100 (43.3)	92.4 (204)

Meaning of "–": not available

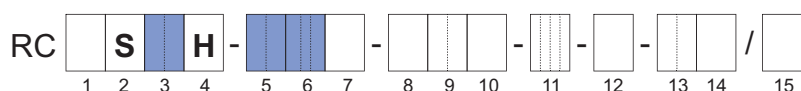

Tab. 6: Overall length L1 and weight of sensor (process connections: EN, wetted parts: Ni alloy C-22/2.4602)

Process connections	Model code pos.		Supreme 34		Supreme 36		Supreme 38		Supreme 39	
	5	6	L1	Weight	L1	Weight	L1	Weight	L1	Weight
			in mm (inch)	in kg (lb)	in mm (inch)	in kg (lb)	in mm (inch)	in kg (lb)	in mm (inch)	in kg (lb)
EN DN25 PN40, type B1, raised face (RF)	25	BD4	390 (15.4)	11.7 (26)	520 (20.5)	15.7 (35)	–	–	–	–
EN DN40 PN40, type B1, raised face (RF)	40		390 (15.4)	13.7 (30)	520 (20.5)	17.5 (39)	–	–	–	–
EN DN50 PN40, type B1, raised face (RF)	50		–	–	520 (20.5)	19.3 (43)	620 (24.4)	28 (62)	–	–
EN DN80 PN40, type B1, raised face (RF)	80		–	–	–	–	620 (24.4)	32.6 (72)	1020 (40.2)	60.8 (134)
EN DN100 PN40, type B1, raised face (RF)	1H		–	–	–	–	–	–	1020 (40.2)	65.1 (144)
EN DN125 PN40, type B1, raised face (RF)	1Q		–	–	–	–	–	–	1020 (40.2)	71.4 (157)

Meaning of "–": not available

### Process connections compatible to JIS B 2220 (AISI 316/ AISI 316 L)

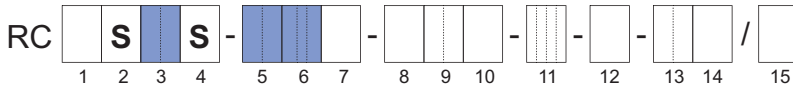

Tab. 7: Overall length L1 and weight of sensor (process connections: JIS, wetted parts: stainless steel)

Process connections	Model code pos.		Supreme 34		Supreme 36		Supreme 38		Supreme 39	
	5	6	L1 in mm (inch)	Weight in kg (lb)	L1 in mm (inch)	Weight in kg (lb)	L1 in mm (inch)	Weight in kg (lb)	L1 in mm (inch)	Weight in kg (lb)
JIS DN15 10K	15	BJ1	370 (14.6)	10.4 (23)	–	–	–	–	–	–
JIS DN15 20K		BJ2	370 (14.6)	10.4 (23)	–	–	–	–	–	–
JIS DN25 10K	25	BJ1	370 (14.6)	11.4 (25)	500 (19.7)	15.6 (34)	–	–	–	–
JIS DN25 20K		BJ2	370 (14.6)	11.8 (26)	500 (19.7)	15.8 (35)	–	–	–	–
JIS DN40 10K	40	BJ1	370 (14.6)	12.2 (27)	500 (19.7)	16.2 (36)	600 (23.6)	25.4 (56)	–	–
JIS DN40 20K		BJ2	370 (14.6)	12.6 (28)	500 (19.7)	16.6 (37)	600 (23.6)	25.8 (57)	–	–
JIS DN50 10K	50	BJ1	–	–	500 (19.7)	17 (37)	600 (23.6)	26 (57)	–	–
JIS DN50 20K		BJ2	–	–	500 (19.7)	17.2 (38)	600 (23.6)	26.2 (58)	–	–
JIS DN80 10K	80	BJ1	–	–	–	–	600 (23.6)	27.8 (61)	1000 (39.4)	57.8 (127)
JIS DN80 20K		BJ2	–	–	–	–	610 (24)	30.4 (67)	1000 (39.4)	60 (132)
JIS DN100 10K	1H	BJ1	–	–	–	–	–	–	1000 (39.4)	59 (130)
JIS DN100 20K		BJ2	–	–	–	–	–	–	1000 (39.4)	63 (139)
JIS DN125 10K	1Q	BJ1	–	–	–	–	–	–	1000 (39.4)	62.8 (138)
JIS DN125 20K		BJ2	–	–	–	–	–	–	1000 (39.4)	69 (152)

Meaning of "–": not available

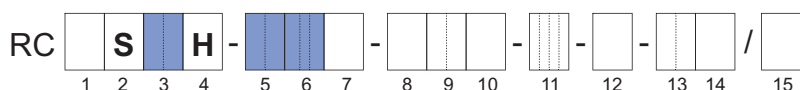

Tab. 8: Overall length L1 and weight of sensor (process connections: JIS, wetted parts: Ni alloy C-22/2.4602)

Process connections	Model code pos.		Supreme 34		Supreme 36		Supreme 38		Supreme 39	
	5	6	L1 in mm (inch)	Weight in kg (lb)	L1 in mm (inch)	Weight in kg (lb)	L1 in mm (inch)	Weight in kg (lb)	L1 in mm (inch)	Weight in kg (lb)
JIS DN25 10K	25	BJ1	390 (15.4)	12.1 (27)	–	–	–	–	–	–
JIS DN25 20K		BJ2	390 (15.4)	12.5 (28)	–	–	–	–	–	–
JIS DN40 10K	40	BJ1	390 (15.4)	13.6 (30)	520 (20.5)	17.4 (38)	–	–	–	–
JIS DN40 20K		BJ2	390 (15.4)	14 (31)	520 (20.5)	17.6 (39)	–	–	–	–
JIS DN50 10K	50	BJ1	–	–	520 (20.5)	18.6 (41)	620 (24.4)	27.3 (60)	–	–
JIS DN50 20K		BJ2	–	–	520 (20.5)	18.8 (41)	620 (24.4)	27.3 (60)	–	–
JIS DN80 10K	80	BJ1	–	–	–	–	620 (24.4)	30.8 (68)	1020 (40.2)	58.8 (130)
JIS DN80 20K		BJ2	–	–	–	–	620 (24.4)	33.3 (73)	1020 (40.2)	61.3 (135)
JIS DN100 10K	1H	BJ1	–	–	–	–	–	–	1020 (40.2)	62.5 (138)
JIS DN100 20K		BJ2	–	–	–	–	–	–	1020 (40.2)	66.7 (147)
JIS DN125 10K	1Q	BJ1	–	–	–	–	–	–	1020 (40.2)	69.6 (153)
JIS DN125 20K		BJ2	–	–	–	–	–	–	1020 (40.2)	76.5 (169)

Meaning of "–": not available

**Process connections compatible to JPI**

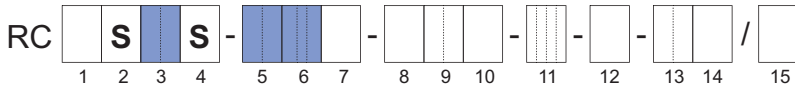

Tab. 9: Overall length L1 and weight of sensor (process connections: JPI, wetted parts: stainless steel)

Process connections	Model code pos.		Supreme 34		Supreme 36		Supreme 38		Supreme 39	
	5	6	L1 in mm (inch)	Weight in kg (lb)	L1 in mm (inch)	Weight in kg (lb)	L1 in mm (inch)	Weight in kg (lb)	L1 in mm (inch)	Weight in kg (lb)
JPI ½" class 150	15	BP1	370 (14.6)	10 (22)	–	–	–	–	–	–
JPI ½" class 300		BP2	370 (14.6)	10.4 (23)	–	–	–	–	–	–
JPI ½" class 600		BP4	380 (15)	10.6 (23)	–	–	–	–	–	–
JPI 1" class 150	25	BP1	370 (14.6)	10.8 (24)	500 (19.7)	14.8 (33)	–	–	–	–
JPI 1" class 300		BP2	370 (14.6)	11.8 (26)	500 (19.7)	15.8 (35)	–	–	–	–
JPI 1" class 600		BP4	390 (15.4)	12.2 (27)	520 (20.5)	16.2 (36)	–	–	–	–
JPI 1½" class 150	40	BP1	380 (15)	12 (26)	500 (19.7)	16 (35)	600 (23.6)	25 (55)	–	–
JPI 1½" class 300		BP2	380 (15)	14 (31)	510 (20.1)	18.2 (40)	600 (23.6)	27 (60)	–	–
JPI 1½" class 600		BP4	400 (15.7)	15.2 (34)	530 (20.9)	19.2 (42)	620 (24.4)	28.2 (62)	–	–
JPI 2" class 150	50	BP1	–	–	510 (20.1)	17.4 (38)	600 (23.6)	26.6 (59)	–	–
JPI 2" class 300		BP2	–	–	510 (20.1)	19.4 (43)	600 (23.6)	28 (62)	–	–
JPI 2" class 600		BP4	–	–	540 (21.3)	20.6 (45)	630 (24.8)	29.6 (65)	–	–
JPI 2½" class 150	65	BP1	–	–	–	–	610 (24)	29.2 (64)	–	–
JPI 2½" class 300		BP2	–	–	–	–	610 (24)	30.8 (68)	–	–
JPI 2½" class 600		BP4	–	–	–	–	640 (25.2)	33 (73)	–	–
JPI 3" class 150	80	BP1	–	–	–	–	610 (24)	30.6 (67)	1000 (39.4)	60 (132)
JPI 3" class 300		BP2	–	–	–	–	620 (24.4)	34.2 (75)	1000 (39.4)	63.4 (140)
JPI 3" class 600		BP4	–	–	–	–	640 (25.2)	37.2 (82)	1000 (39.4)	65.4 (144)
JPI 4" class 150	1H	BP1	–	–	–	–	–	–	1000 (39.4)	63.6 (140)
JPI 4" class 300		BP2	–	–	–	–	–	–	1000 (39.4)	71.2 (157)
JPI 4" class 600		BP4	–	–	–	–	–	–	1030 (40.6)	81.2 (179)

Process connections	Model code pos.		Supreme 34		Supreme 36		Supreme 38		Supreme 39	
	5	6	L1 in mm (inch)	Weight in kg (lb)	L1 in mm (inch)	Weight in kg (lb)	L1 in mm (inch)	Weight in kg (lb)	L1 in mm (inch)	Weight in kg (lb)
JPI 5" class 150	1Q	BP1	–	–	–	–	–	–	1000 (39.4)	65.2 (144)
JPI 5" class 300		BP2	–	–	–	–	–	–	1000 (39.4)	77 (170)

Meaning of "–": not available

**Process connections with internal thread G**

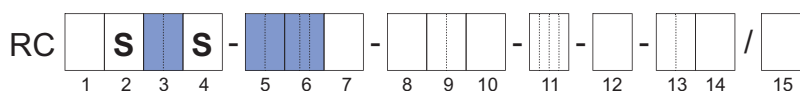

Tab. 10: Overall length L1 and weight of sensor (process connections: G thread, wetted parts: stainless steel)

Process connections	Model code pos.		Supreme 34		Supreme 36		Supreme 38		Supreme 39	
	5	6	L1 in mm (inch)	Weight in kg (lb)	L1 in mm (inch)	Weight in kg (lb)	L1 in mm (inch)	Weight in kg (lb)	L1 in mm (inch)	Weight in kg (lb)
G 3/8"	08	TG9	390 (15.4)	9.4 (21)	–	–	–	–	–	–
G 1/2"	15		390 (15.4)	9.4 (21)	–	–	–	–	–	–
G 3/4"	20		390 (15.4)	9.4 (21)	–	–	–	–	–	–

Meaning of "–": not available

**Process connections with internal thread NPT**

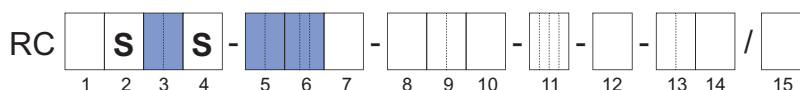

Tab. 11: Overall length L1 and weight of sensor (process connections: NPT thread, wetted parts: stainless steel)

Process connections	Model code pos.		Supreme 34		Supreme 36		Supreme 38		Supreme 39	
	5	6	L1 in mm (inch)	Weight in kg (lb)	L1 in mm (inch)	Weight in kg (lb)	L1 in mm (inch)	Weight in kg (lb)	L1 in mm (inch)	Weight in kg (lb)
NPT 3/8"	08	TT9	390 (15.4)	9.4 (21)	–	–	–	–	–	–
NPT 1/2"	15		390 (15.4)	9.4 (21)	–	–	–	–	–	–
NPT 3/4"	20		390 (15.4)	9.4 (21)	–	–	–	–	–	–

Meaning of "–": not available

### Threaded connection compatible to DIN 11851

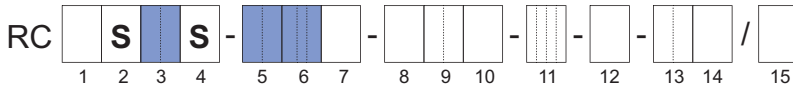

Tab. 12: Overall length L1 and weight of sensor (process connections: DIN 11851 threaded)

Process connections	Model code pos.		Supreme 34		Supreme 36		Supreme 38		Supreme 39	
	5	6	L1 in mm (inch)	Weight in kg (lb)	L1 in mm (inch)	Weight in kg (lb)	L1 in mm (inch)	Weight in kg (lb)	L1 in mm (inch)	Weight in kg (lb)
DIN 11851 DN25	25	HS2	370 (14.6)	9.4 (20.7)	–	–	–	–	–	–
DIN 11851 DN50	50		–	–	–	–	600 (23.6)	22.8 (50.3)	–	–

Meaning of "–": not available

### Clamp process connections according to DIN 32676 series A

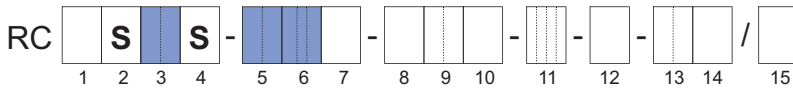

Tab. 13: Overall length L1 and weight of sensor (process connections: DIN 32676 series A clamp, wetted parts: stainless steel)

Process connections	Model code pos.		Supreme 34		Supreme 36		Supreme 38		Supreme 39	
	5	6	L1 in mm (inch)	Weight in kg (lb)	L1 in mm (inch)	Weight in kg (lb)	L1 in mm (inch)	Weight in kg (lb)	L1 in mm (inch)	Weight in kg (lb)
DIN 32676 series A DN25	25	HS4	370 (14.6)	9.2 (20)	–	–	–	–	–	–
DIN 32676 series A DN40	40		370 (14.6)	9.2 (20)	500 (19.7)	13.2 (29)	–	–	–	–
DIN 32676 series A DN50	50		–	–	500 (19.7)	13.2 (29)	600 (23.6)	22.4 (49)	–	–
DIN 32676 series A DN65	65		–	–	–	–	600 (23.6)	22.5 (50)	–	–
DIN 32676 series A DN100	1H		–	–	–	–	–	–	1000 (39.4)	52.1 (115)

Meaning of "–": not available

Clamp process connections according to DIN 32676 series C (Tri-Clamp)

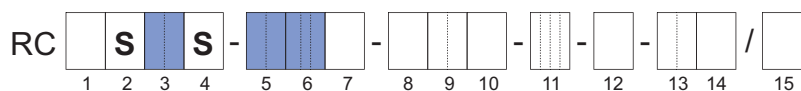

Tab. 14: Overall length L1 and weight of sensor (process connections: DIN 32676 series C Tri-Clamp, wetted parts: stainless steel)

Process connections	Model code pos.		Supreme 34		Supreme 36		Supreme 38		Supreme 39	
	5	6	L1 in mm (inch)	Weight in kg (lb)	L1 in mm (inch)	Weight in kg (lb)	L1 in mm (inch)	Weight in kg (lb)	L1 in mm (inch)	Weight in kg (lb)
DIN 32676 series C 1"	25	HS8	370 (14.6)	9.2 (20)	-	-	-	-	-	-
DIN 32676 series C 1½"	40		370 (14.6)	9.2 (20)	500 (19.7)	13.2 (29)	-	-	-	-
DIN 32676 series C 2"	50		-	-	500 (19.7)	13.2 (29)	600 (23.6)	22.4 (49)	-	-
DIN 32676 series C 3"	80		-	-	-	-	600 (23.6)	22.5 (50)	1000 (39.4)	52.2 (115)
DIN 32676 series C 4"	1H		-	-	-	-	-	-	1000 (39.4)	52.2 (115)

Meaning of "-": not available

Clamp process connections according to DIN 11864 2-BF form A

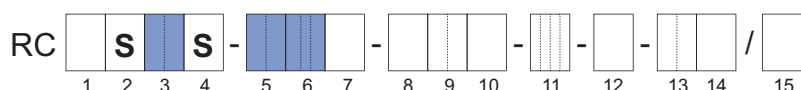

Tab. 15: Overall length L1 and weight of sensor (process connections: DIN 11864 2-BF form A, wetted parts: stainless steel)

Process connections	Model code pos.		Supreme 34		Supreme 36		Supreme 38		Supreme 39	
	5	6	L1 in mm (inch)	Weight in kg (lb)	L1 in mm (inch)	Weight in kg (lb)	L1 in mm (inch)	Weight in kg (lb)	L1 in mm (inch)	Weight in kg (lb)
DIN 11864-2-BF Form A DN50	50	HS3	-	-	-	-	610 (24)	23 (50.7)	-	-
DIN 11864-2-BF Form A DN80	80		-	-	-	-	630 (24.8)	24.1 (53.1)	1000 (39.4)	53.3 (117.5)
DIN 11864-2-BF Form A DN1H	1H		-	-	-	-	-	-	1000 (39.4)	54.1 (119.3)

Meaning of "-": not available

### Clamp process connection according to JIS/ISO 2852

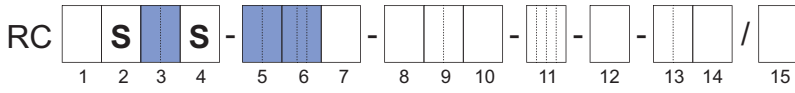

Tab. 16: Overall length L1 and weight of sensor (process connections: JIS/ISO 2852 clamp, wetted parts: stainless steel)

Process connections	Model code pos.		Supreme 34		Supreme 36		Supreme 38		Supreme 39	
	5	6	L1 in mm (inch)	Weight in kg (lb)	L1 in mm (inch)	Weight in kg (lb)	L1 in mm (inch)	Weight in kg (lb)	L1 in mm (inch)	Weight in kg (lb)
JIS/ISO 2852 1"	25	HS9	370 (14.6)	9.2 (20)	–	–	–	–	–	–
JIS/ISO 2852 1½"	40		370 (14.6)	9.2 (20)	500 (19.7)	13.2 (29)	–	–	–	–
JIS/ISO 2852 2"	50		–	–	500 (19.7)	13.3 (29)	600 (23.6)	22.4 (49)	–	–
JIS/ISO 2852 3"	80		–	–	–	–	600 (23.6)	22.5 (50)	–	–

Meaning of "–": not available

## NAMUR &amp; Customer length

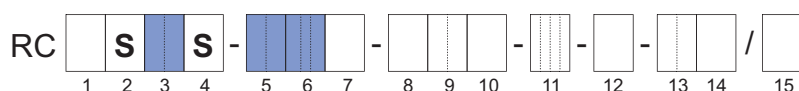

## Overall length and weight for customized installation length

Tab. 17: Available process connections for options NL and CL with minimum and maximum installation length

Model code pos.		Supreme 34		Supreme 36		Supreme 38		Supreme 39	
5	6	CL min in mm (inch)	CL max (NL) in mm (inch)	CL min in mm (inch)	CL max (NL) in mm (inch)	CL min in mm (inch)	CL max (NL) in mm (inch)	CL min in mm (inch)	CL max (NL) in mm (inch)
15	BA1, BA2, BD4, BJ1, BJ2, BP1, BP2, ED4, FD4, GD4	430 (16.9)	510 (20.1)	–	–	–	–	–	–
	BA4, BP4, CA4	440 (17.3)	510 (20.1)	–	–	–	–	–	–
25	BA1, BA2, BD4, BJ1, BJ2, BP1, BP2, ED4, FD4, GD4	430 (16.9)	600 (23.6)	560 (22)	600 (23.6)	–	–	–	–
	BA4, BP4, CA4	450 (17.7)	600 (23.6)	580 (22.8)	600 (23.6)	–	–	–	–
40	BD4, BJ1, BJ2, ED4, FD4, GD4	430 (16.9)	600 (23.6)	560 (22)	600 (23.6)	–	–	–	–
	BA1, BP1	440 (22)	600 (23.6)	560 (22)	600 (23.6)	–	–	–	–
	BA2, BP2	440 (17.3)	600 (23.6)	570 (22.4)	600 (23.6)	–	–	–	–
	BA4, BP4, CA4	460 (18.1)	600 (23.6)	590 (23.2)	600 (23.6)	–	–	–	–
50	BD4, BJ1, BJ2, ED4, FD4, GD4	–	–	560 (22)	715 (28.1)	660 (26)	715 (28.1)	–	–
	BA1, BP1, BA2, BP2	–	–	570 (22.4)	715 (28.1)	660 (26)	715 (28.1)	–	–
	BA4, BP4, CA4	–	–	600 (23.6)	715 (28.1)	690 (27.2)	715 (28.1)	–	–
65	BA1, BP1, BA2, BP2	–	–	–	–	670 (26.4)	715 (28.1)	–	–
	BA4, BP4, CA4	–	–	–	–	700 (27.6)	715 (28.1)	–	–
80	BJ1	–	–	–	–	660 (26)	915 (36)	–	–
	BA1, BD4, BJ2, BP1, ED4, FD4, GD4	–	–	–	–	670 (26.4)	915 (36)	–	–
	BA2, BP2	–	–	–	–	680 (26.8)	915 (36)	–	–
	BA4, BP4, CA4	–	–	–	–	700 (27.6)	915 (36)	–	–

Model code pos.		Supreme 34		Supreme 36		Supreme 38		Supreme 39	
5	6	CL min in mm (inch)	CL max (NL) in mm (inch)	CL min in mm (inch)	CL max (NL) in mm (inch)	CL min in mm (inch)	CL max (NL) in mm (inch)	CL min in mm (inch)	CL max (NL) in mm (inch)
1H	BA1, BA2, BD4, BJ1, BJ2, BP1, BP2, ED4, FD4, GD4	–	–	–	–	–	–	1060 (41.7)	1400 (55.1)
	BA4, BP4, CA4	–	–	–	–	–	–	1090 (42.9)	1400 (55.1)
1Q	BA1, BA2, BD4, BJ1, BJ2, BP1, BP2, ED4, FD4, GD4	–	–	–	–	–	–	1060 (41.7)	1400 (55.1)
	BA4, CA4	–	–	–	–	–	–	1100 (43.3)	1400 (55.1)

Meaning of "–": not available, "CL": Customer length, "NL": NAMUR length; NL corresponds to CL max

Tab. 18: Additional weight in combination with options NL and CL

	Supreme 34	Supreme 36	Supreme 38	Supreme 39
Additional weight for customized installation length in kg/mm	0.003	0.005	0.008	0.014

### Typical dimensions of measuring tubes

Tab. 19: Typical dimensions of measuring tubes

Meter size	Material of wetted parts	Model code pos. 4	Internal diameter in mm (inch)	Wall thickness in mm (inch)
Supreme 34	Stainless steel 1.4404/316L	S	7.75 (0.305)	0.89 (0.035)
	Nickel alloy C-22/2.4602	H	7.70 (0.303)	0.91 (0.036)
Supreme 36	Stainless steel 1.4404/316L	S	13.40 (0.528)	1.24 (0.049)
	Nickel alloy C-22/2.4602	H	13.40 (0.528)	1.24 (0.049)
Supreme 38	Stainless steel 1.4404/316L	S	22.10 (0.870)	1.65 (0.065)
	Nickel alloy C-22/2.4602	H	22.10 (0.870)	1.65 (0.065)
Supreme 39	Stainless steel 1.4404/316L	S	37.20 (1.485)	2.60 (0.102)
	Nickel alloy C-22/2.4602	H	36.70 (1.445)	2.77 (0.109)

**Additional weight for insulation and heat tracing**

Tab. 20: Additional weight for insulation and heat tracing

Model code pos. 15	Description	Process connection	Weight in kg (lb)			
			Supreme 34	Supreme 36	Supreme 38	Supreme 39
/T10	Insulation	–	4.4 (9.7)	6.4 (14.1)	8.2 (18.1)	24 (52.9)
/T21 <sup>1)</sup>	Insulation and heat tracing	ASME ½" class 150, raised face (RF)	2.3 (5.1)	3.2 (7.1)	3.5 (7.7)	10.1 (22.3)
/T22 <sup>1)</sup>		ASME ½" class 300, raised face (RF)				
/T26 <sup>1)</sup>		EN DN15 PN40				
/T31 <sup>1)</sup>	Insulation and heat tracing with purging	ASME ½" class 150, raised face (RF)	2.5 (5.5)	3.4 (7.5)	3.7 (8.2)	10.3 (22.7)
/T32 <sup>1)</sup>		ASME ½" class 300, raised face (RF)				
/T36 <sup>1)</sup>		EN DN15 PN40				

<sup>1)</sup> Weights from insulation (T10) have to be considered additionally.

## 2 Transmitter dimensions and weights

### Transmitter dimensions

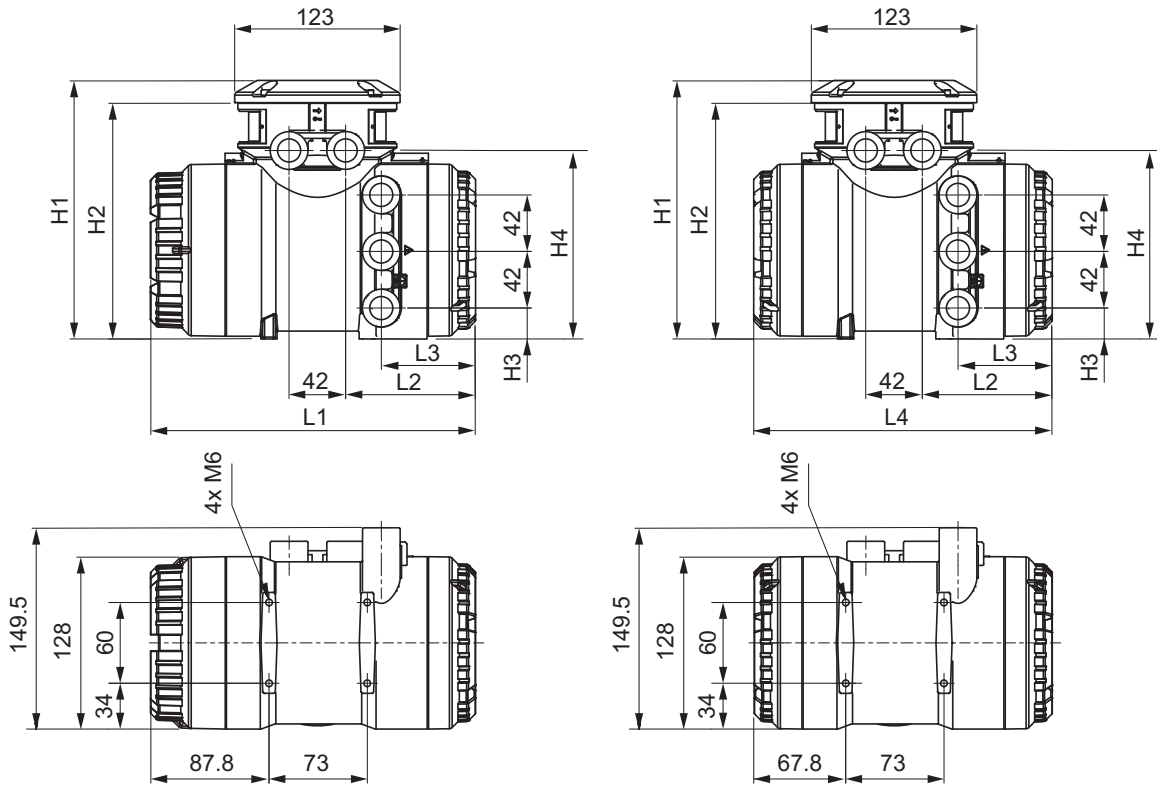

Fig. 3: Dimensions of transmitter in mm  
(left: transmitter with display, right: transmitter without display)

Tab. 21: Overall length L1 - L4 and height H1 - H4 of transmitter (material: stainless steel, aluminum)

Material	L1 in mm (inch)	L2 in mm (inch)	L3 in mm (inch)	L4 in mm (inch)	H1 in mm (inch)	H2 in mm (inch)	H3 in mm (inch)	H4 in mm (inch)
Stainless steel	255.5 (10.06)	110.5 (4.35)	69 (2.72)	235 (9.25)	201 (7.91)	184 (7.24)	24 (0.94)	150.5 (5.93)
Aluminum	241.5 (9.51)	96.5 (3.8)	70 (2.76)	221 (8.7)	192 (7.56)	175 (6.89)	23 (0.91)	140 (5.51)

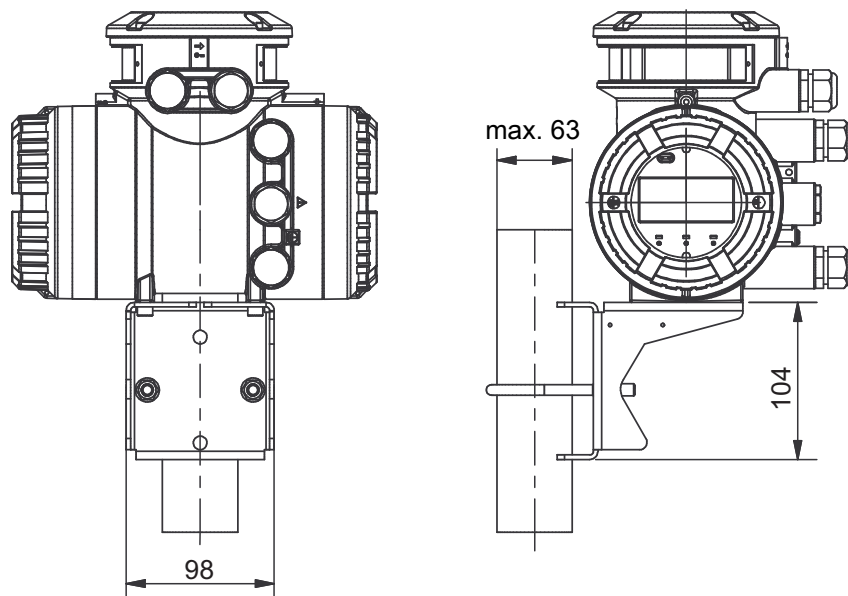
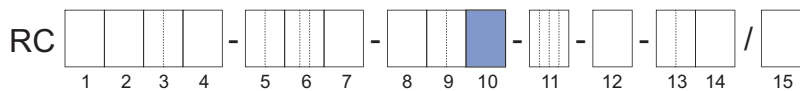

Fig. 4: Dimensions of transmitter in mm, attached to mounting bracket.

Transmitter weights



Model code (pos. 10)	Design type	Housing material of transmitter	Weight in kg (lb)
A, B, E, F	Remote	Aluminum	max. 4.4 (9.7)
J, K		Stainless steel	12.5 (27.6)

### 3 Wiring

#### 3.1 Terminal configuration diagrams

##### 3.1.1 Terminal for connection between sensor and transmitter

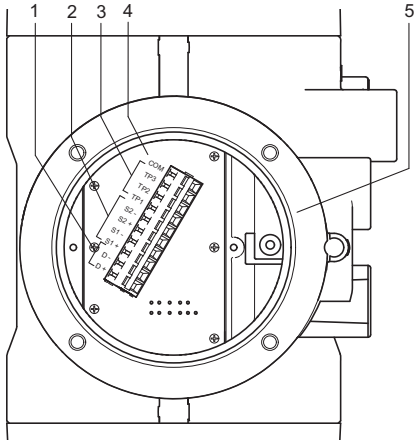

Fig. 5: Connection terminal circuits (transmitter on the left side, sensor on the right side)

- |   |   |   |                  |
|---|---|---|------------------|
| 1 | Driver circuit (D+/D-)                          | 4 | Signal grounding |
| 2 | Sensor circuits (S1+/S1-, S2+/S2-)              | 5 | Transmitter      |
| 3 | Temperature measurement circuit (TP1, TP2, TP3) | 6 | Sensor           |

##### 3.1.2 Terminal for I/O outputs and power supply

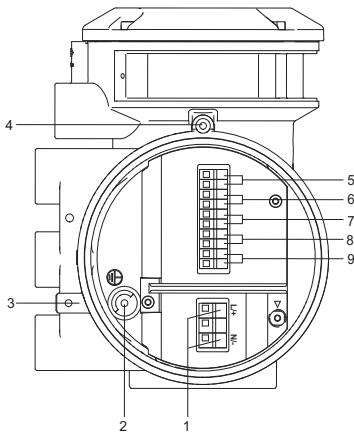

Fig. 6: Terminal for I/O outputs and power supply in transmitter

- |   |                                   |   |                                   |
|---|-----------------------------------|---|-----------------------------------|
| 1 | Power supply connection terminals | 6 | Connection terminals for I/O2 +/- |
| 2 | Grounding screw in terminal box   | 7 | Connection terminals for I/O3 +/- |
| 3 | Grounding transmitter housing     | 8 | Connection terminals for I/O4 +/- |
| 4 | Locking screw                     | 9 | WP: Write-protection terminal     |
| 5 | Connection terminals for I/O1 +/- |   |                                   |

## 4 Connecting cable dimensions and weights

### 4.1 Standard cable (option /L\_ without option /LAC)

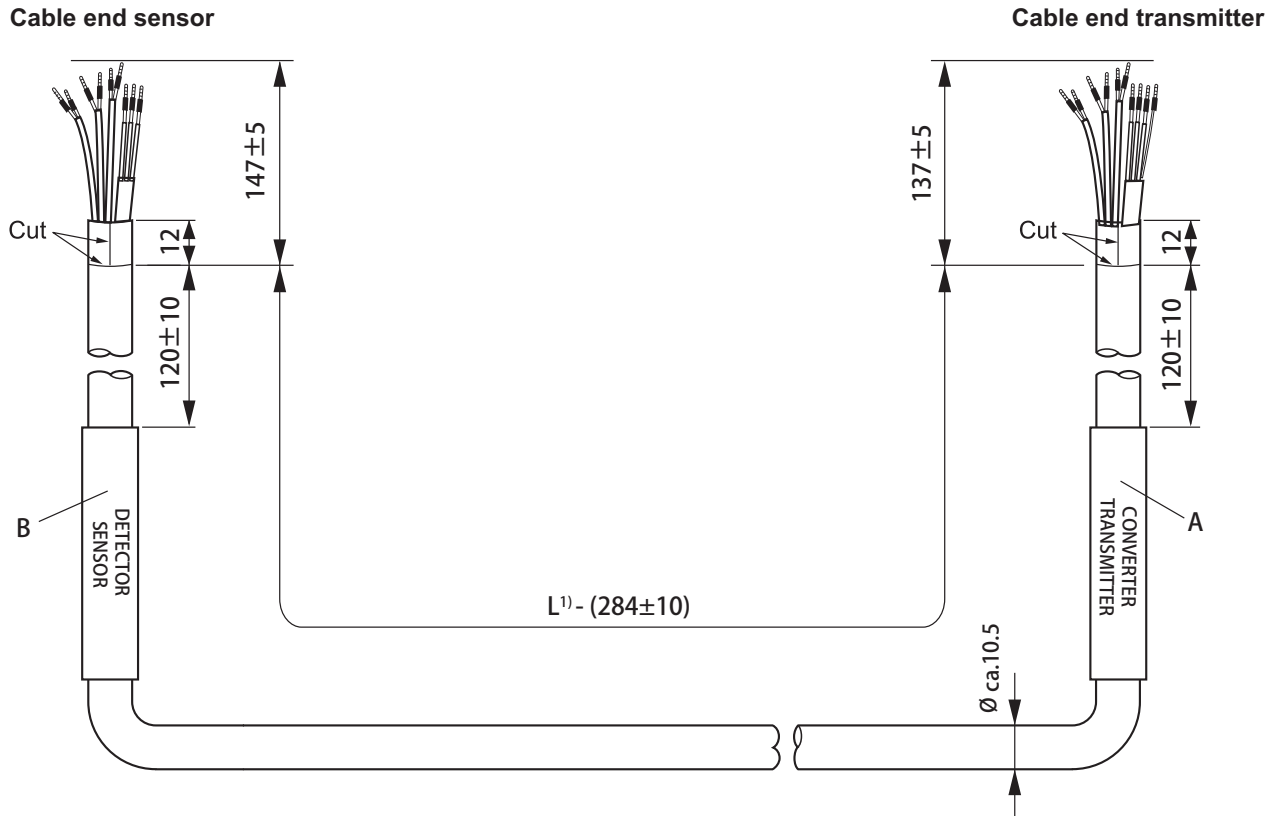

Fig. 7: Dimensions of standard cable (option /L\_ without option /LAC), terminated in mm and labelling

Label number	Label name	Installation status
A	CONVERTER/TRANSMITTER	Factory labeled
B	DETECTOR/SENSOR	

<sup>1)</sup> L: Length of connecting cable

Options	Length of connecting cable in m (ft)	Colour of connecting cable
/L000	Without connecting cable	Non Ex: gray / Ex: blue
/L005	5 m (16.4 ft)	
/L010	10 m (32.8 ft)	
/L015	15 m (49.2 ft)	
/L020	20 m (65.6 ft)	
/L030	30 m (98.4 ft)	

- Weight of cable  $\leq 0.200$  kg/m (0.134 lb/ft)

A cable assembly kit is included for possible repairs.

4.2 Steel armored cable (option /L\_ with option /LAC)

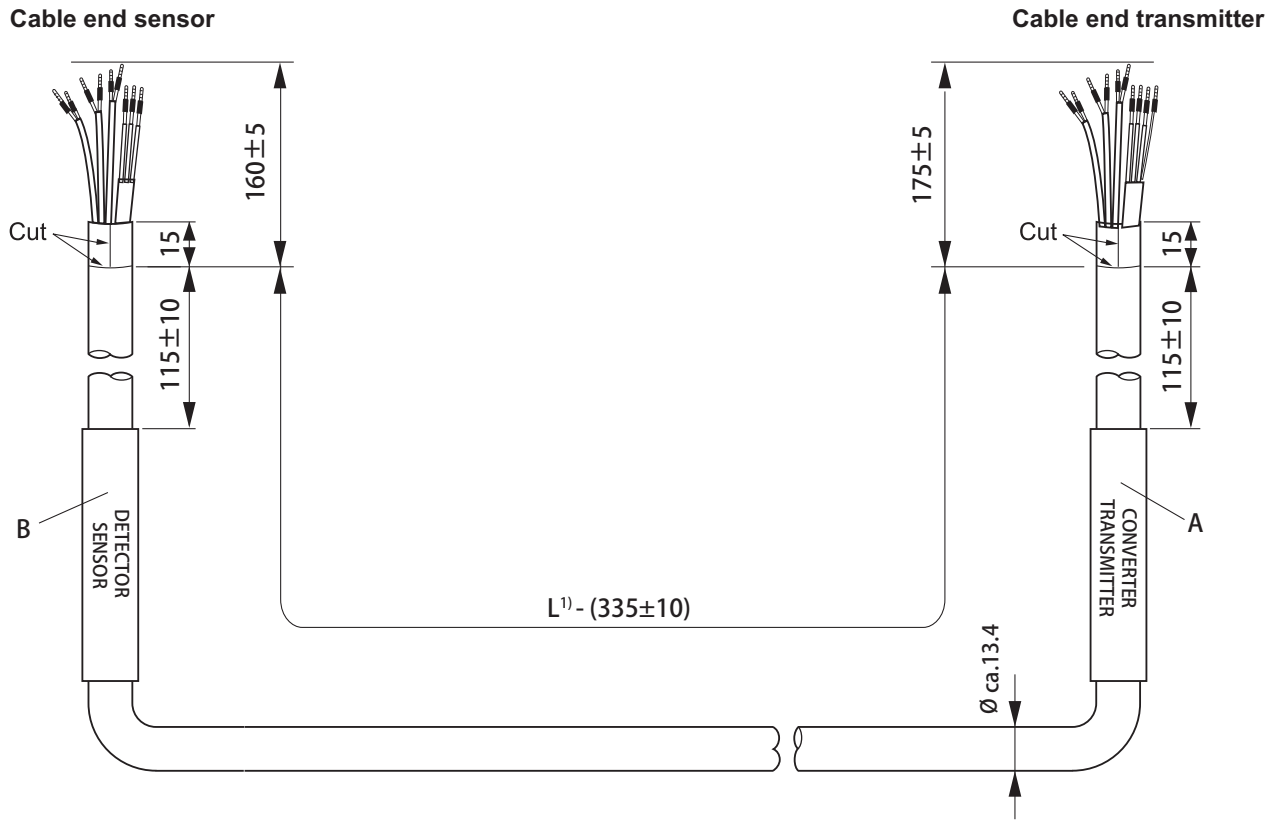

Fig. 8: Dimensions of standard cable (option /L\_ with option /LAC), terminated in mm and labelling

Label number	Label name	Installation status
A	CONVERTER/TRANSMITTER	Factory labeled
B	DETECTOR/SENSOR	

¹) L: Length of connecting cable

Options	Length of connecting cable in m (ft)	Colour of connecting cable
/L005, /LAC	5 m (16.4 ft)	Blue
/L010, /LAC	10 m (32.8 ft)	
/L015, /LAC	15 m (49.2 ft)	
/L020, /LAC	20 m (65.6 ft)	
/L030, /LAC	30 m (98.4 ft)	

- Weight of cable ≤ 0.300 kg/m (0.202 lb/ft)

A cable assembly kit is included for possible repairs.

4.3 Fire retardant cable (option /Y\_...)

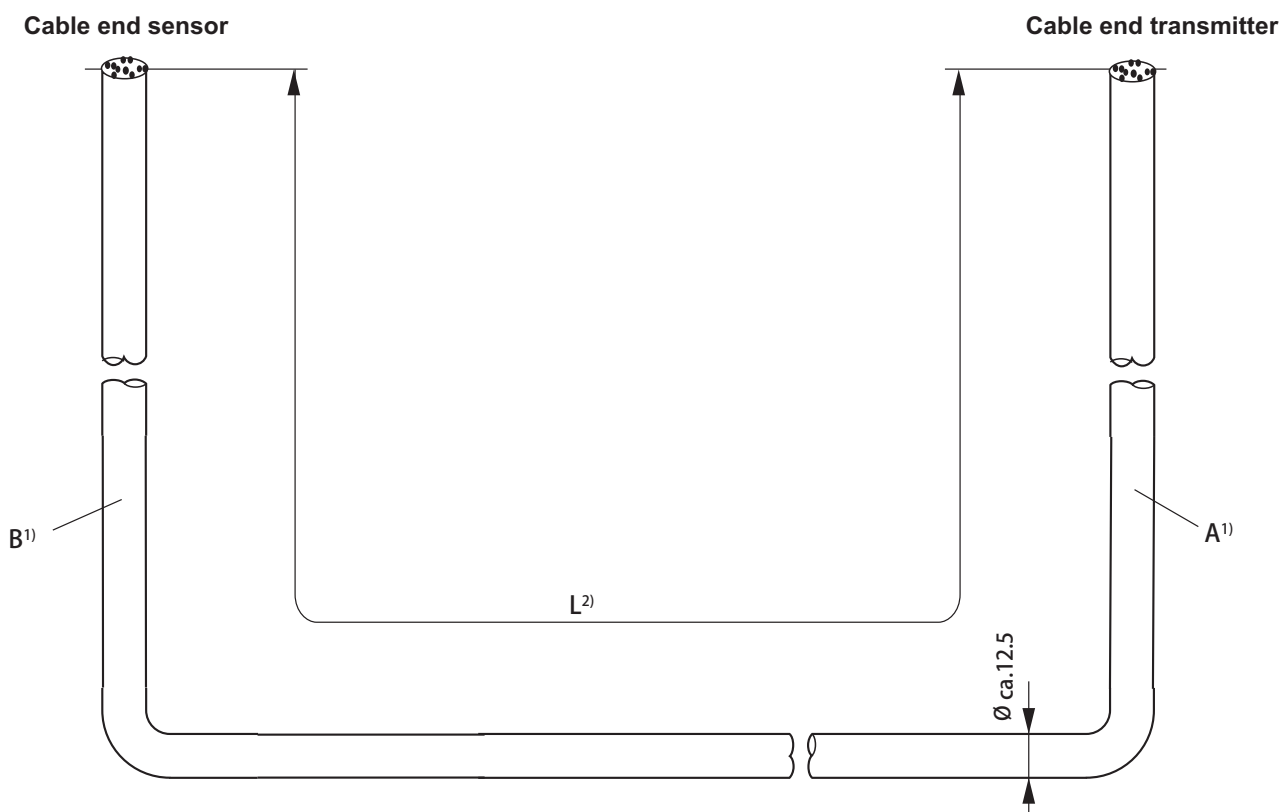

Fig. 9: Dimensions of fire retardant cable (option /Y\_...), not terminated<sup>3)</sup> in mm and labelling

Label number	Label name	Installation status
A	CONVERTER/TRANSMITTER	Separately enclosed
B	DETECTOR/SENSOR	

<sup>1)</sup> Installation of label A/B: Label A/B is included in termination kit. Install the label inside an appropriate cable area near the mounted cable gland.

<sup>2)</sup> L: Length of connecting cable

<sup>3)</sup> The cable can also be supplied pre-assembled.

Options	Length of connecting cable in m (ft)	Colour of connecting cable
/Y000	Without connecting cable	Gray
/Y005	5 m (16.4 ft)	
/Y010	10 m (32.8 ft)	
/Y015	15 m (49.2 ft)	
/Y020	20 m (65.6 ft)	
/Y030	30 m (98.4 ft)	

- Weight of cable  $\leq 0.270$  kg/m (0.181 lb/ft)

A cable assembly kit with instructions is included.

5 Japan Ex cable gland dimensions (option /V5\_)

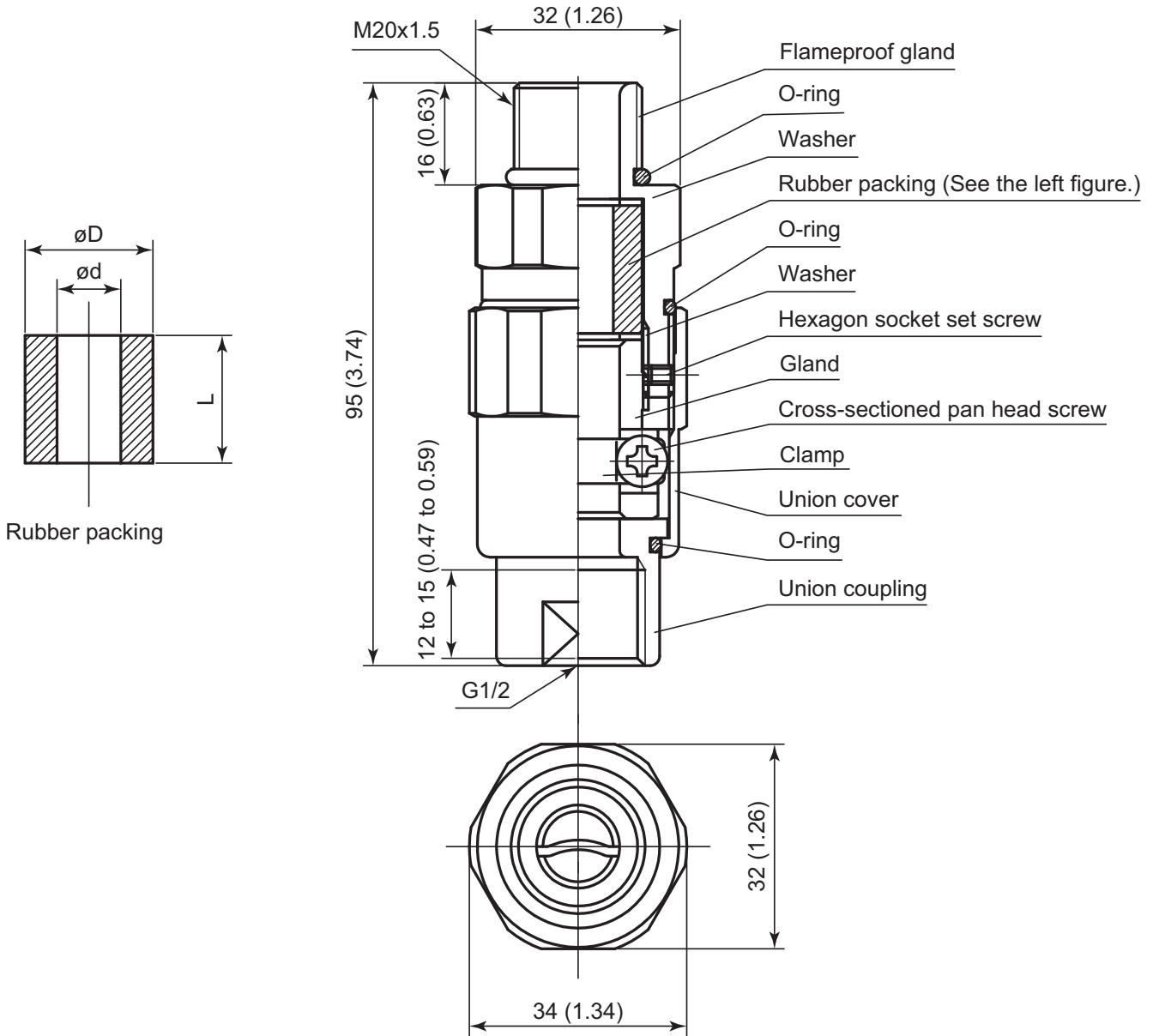

Fig. 10: Dimensions of cable gland (option V5\_), in mm (inch)

Dimensions of rubber packing (before compression)			Identification mark of rubber packing	Cable outer diameter	
L	Ø D	Ø d		Min.	Max.
in mm (inch)					
20 (0.79)	Ø 20 (0.79)	Ø 10 (0.39)	Ø 10 (0.39)	Ø 8.0 (0.31)	Ø 10.0 (0.39)
20 (0.79)	Ø 20 (0.79)	Ø 12 (0.47)	Ø 12 (0.47)	Ø 10.0 (0.39)	Ø 12.0 (0.47)

(Blank page)

---

## TRADEMARKS

ROTAMASS:	registered trademark of Rota Yokogawa GmbH & Co. KG, DE
TRI-CLAMP:	registered trademark of ALFA LAVAL CORPORATE AB, SE

All company and product names mentioned in this document are trade names, trademarks or registered trademarks of their respective companies. In this document, trademarks or registered trademarks are not marked with <sup>TM</sup> or ®.

*All rights reserved. Copyright © 2026-05-20*

Manufacturer:

Rota Yokogawa GmbH & Co. KG  
Rheinstr. 8  
D-79664 Wehr  
Germany

For the actual manufacturing location of your device refer to the model code and/or serial number.

