

Drawings

ROTAMASS Total Insight Coriolis Mass Flow and Density Meter Hygienic



SD 01U10B06-00EN-R



Table of contents

1	Process connections, dimensions and weights of sensor	3
2	Transmitter dimensions and weights	8
3	Wiring	10
3.1	Terminal configuration diagrams	10
3.1.1	Terminal for connection between sensor and transmitter	10
3.1.2	Terminal for I/O outputs and power supply	10
4	Connecting cable dimensions and weights.....	11
4.1	Standard cable (option /L_ _ _ without option /LAC)	11
4.2	Steel armored cable (option /L_ _ _ with option /LAC)	12
4.3	Fire retardant cable (option /Y_ _ _)	13
5	Japan Ex cable gland dimensions (option /V5_).....	14

1 Process connections, dimensions and weights of sensor

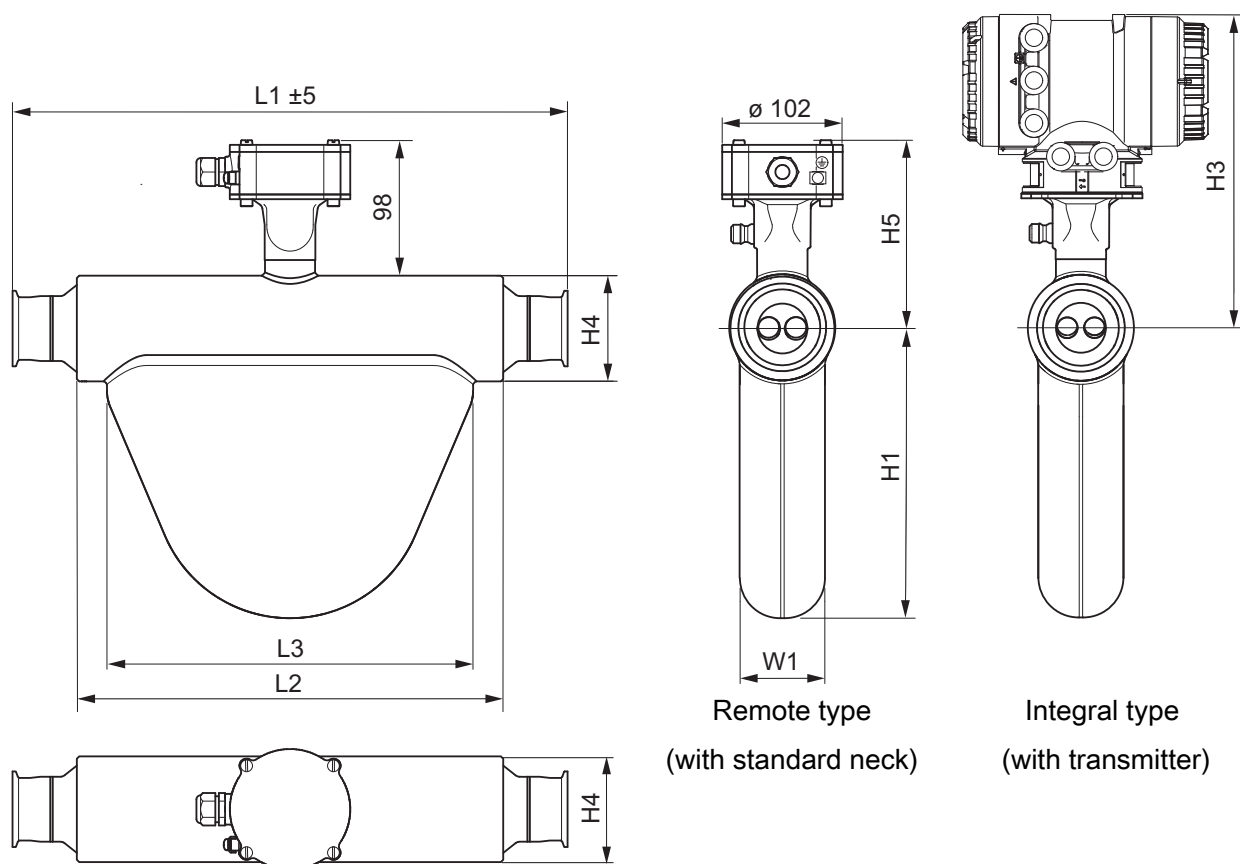

Fig. 1: Dimensions in mm

Tab. 1: Dimensions without length L1

Meter size	L2	L3	H1	H3	H4	H5	W1
	in mm (inch)						
Hygienic 25	190 (7.5)	165 (6.5)	117 (4.6)	268 (10.6)	56 (2.2)	138 (5.4)	42 (1.7)
Hygienic 40	227 (8.9)	195 (7.7)	145 (5.7)	277 (10.9)	71 (2.8)	148 (5.8)	50 (2)
Hygienic 50	361 (14.2)	310 (12.2)	245 (9.6)	289 (11.4)	90 (3.5)	159 (6.3)	72 (2.8)
Hygienic 80	455 (17.9)	400 (15.7)	333 (13.1)	296 (11.7)	102 (4)	167 (6.6)	96 (3.8)

Overall length L1 and weight

The overall length of the sensor depends on the selected process connection (type and size). The following tables list the overall length and weight as functions of the individual process connection.

The weights in the tables are for the remote type. Additional weight for the integral type: up to 3.2 kg (7.1 lb).

Threaded connection compatible to DIN 11851

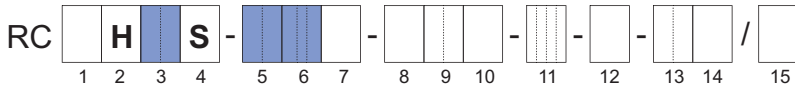

Tab. 2: Overall length L1 and weight of sensor (process connections: DIN 11851 threaded)

Process connections	Model code pos.		Hygienic 25		Hygienic 40		Hygienic 50		Hygienic 80	
	5	6	L1 in mm (inch)	Weight in kg (lb)	L1 in mm (inch)	Weight in kg (lb)	L1 in mm (inch)	Weight in kg (lb)	L1 in mm (inch)	Weight in kg (lb)
DIN 11851 DN25	25	HS2	280 (11)	5,4 (12)	320 (12.6)	7,4 (16)	–	–	–	–
DIN 11851 DN40	40		290 (11.4)	5,5 (12)	330 (13)	7,5 (17)	490 (19.3)	14.3 (32)	–	–
DIN 11851 DN50	50		–	–	–	–	480 (18.9)	14.4 (32)	610 (24)	23.4 (52)
DIN 11851 DN65	65		–	–	–	–	–	–	590 (23.2)	23.4 (52)
DIN 11851 DN80	80		–	–	–	–	–	–	590 (23.2)	23.8 (52)

Meaning of "–": not available

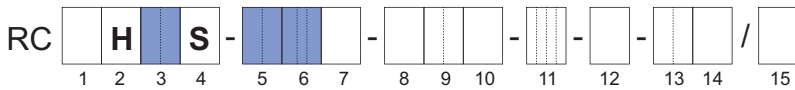

Threaded connection compatible to SMS1145

Tab. 3: Overall length L1 and weight of sensor (process connections: SMS1145 threaded)

Process connections	Model code pos.		Hygienic 25		Hygienic 40		Hygienic 50		Hygienic 80	
	5	6	L1 in mm (inch)	Weight in kg (lb)	L1 in mm (inch)	Weight in kg (lb)	L1 in mm (inch)	Weight in kg (lb)	L1 in mm (inch)	Weight in kg (lb)
SMS1145 DN25	25	HS6	280 (11)	5.2 (11)	320 (12.6)	7.2 (16)	–	–	–	–
SMS1145 DN40	40		–	–	330 (13)	7,5 (17)	490 (19.3)	14.4 (32)	–	–
SMS1145 DN50	50		–	–	–	–	480 (18.9)	14.3 (32)	610 (24)	23.5 (52)
SMS1145 DN65	65		–	–	–	–	–	–	590 (23.2)	23.5 (52)
SMS1145 DN80	80		–	–	–	–	–	–	590 (23.2)	23.7 (52)

Meaning of "–": not available

Clamp process connections according to DIN 32676 series A

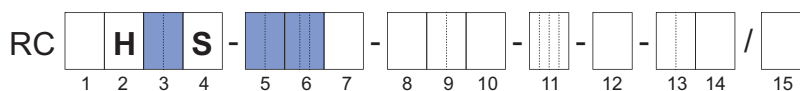

Tab. 4: Overall length L1 and weight of sensor (process connections: DIN 32676 series A clamp)

Process connections	Model code pos.		Hygienic 25		Hygienic 40		Hygienic 50		Hygienic 80	
	5	6	L1 in mm (inch)	Weight in kg (lb)	L1 in mm (inch)	Weight in kg (lb)	L1 in mm (inch)	Weight in kg (lb)	L1 in mm (inch)	Weight in kg (lb)
DIN 32676 series A DN25	25	HS4	280 (11)	5,2 (11)	320 (12.6)	7,2 (16)	–	–	–	–
DIN 32676 series A DN40	40		280 (11)	5,2 (11)	320 (12.6)	7,2 (16)	470 (18.5)	14 (31)	–	–
DIN 32676 series A DN50	50		–	–	–	–	470 (18.5)	14 (31)	600 (23.6)	22.9 (50)
DIN 32676 series A DN65	65		–	–	–	–	–	–	590 (23.2)	23 (51)
DIN 32676 series A DN80	80		–	–	–	–	–	–	590 (23.2)	23.1 (51)

Meaning of "–": not available

Clamp process connections according to DIN 32676 series C (Tri-Clamp)

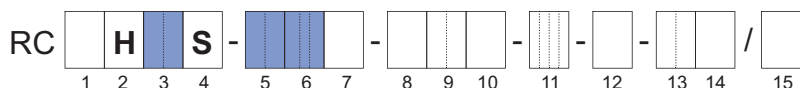

Tab. 5: Overall length L1 and weight of sensor (process connections: DIN 32676 series C Tri-Clamp)

Process connections	Model code pos.		Hygienic 25		Hygienic 40		Hygienic 50		Hygienic 80	
	5	6	L1 in mm (inch)	Weight in kg (lb)	L1 in mm (inch)	Weight in kg (lb)	L1 in mm (inch)	Weight in kg (lb)	L1 in mm (inch)	Weight in kg (lb)
DIN 32676 series C 1"	25	HS8	280 (11)	5.6 (12)	320 (12.6)	7.6 (16.8)	–	–	–	–
DIN 32676 series C 1½"	40		280 (11)	5.7 (12.6)	320 (12.6)	7.7 (17)	480 (18.9)	14.5 (32)	–	–
DIN 32676 series C 2"	50		–	–	–	–	470 (18.5)	14.6 (32.2)	600 (23.6)	23.5 (51.8)
DIN 32676 series C 2½"	65		–	–	–	–	–	–	580 (22.8)	22.8 (50)
DIN 32676 series C 3"	80		–	–	–	–	–	–	600 (23.6)	24.2 (53.4)

Meaning of "–": not available

Hygienic

Process connections, dimensions and weights of sensor

Clamp process connections according to DIN 11864 2-BF form A

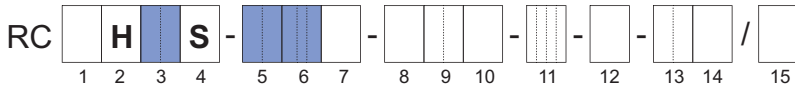

Tab. 6: Overall length L1 and weight of sensor (process connections: DIN 11864-2-BF Form A)

Process connections	Model code pos.		Hygienic 25		Hygienic 40		Hygienic 50		Hygienic 80	
	5	6	L1 in mm (inch)	Weight in kg (lb)	L1 in mm (inch)	Weight in kg (lb)	L1 in mm (inch)	Weight in kg (lb)	L1 in mm (inch)	Weight in kg (lb)
DIN 11864-2-BF Form A DN25	25	HS3	280 (11)	5.6 (12.4)	320 (12.6)	7.6 (16.8)	–	–	–	–
DIN 11864-2-BF Form A DN40	40		280 (11)	5.7 (12.6)	320 (12.6)	7.7 (17)	480 (18.9)	14.5 (32)	–	–
DIN 11864-2-BF Form A DN50	50		–	–	–	–	470 (18.5)	14.6 (32.2)	600 (23.6)	23.5 (51.8)
DIN 11864-2-BF Form A DN80	80		–	–	–	–	–	–	600 (23.6)	24.2 (53.4)

Meaning of "–": not available

Clamp process connection according to JIS/ISO 2852

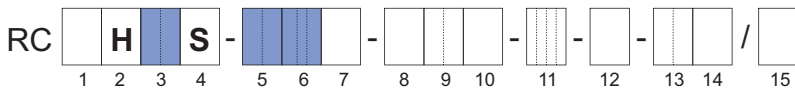

Tab. 7: Overall length L1 and weight of sensor (process connections: JIS/ISO 2852 clamp)

Process connections	Model code pos.		Hygienic 25		Hygienic 40		Hygienic 50		Hygienic 80	
	5	6	L1 in mm (inch)	Weight in kg (lb)	L1 in mm (inch)	Weight in kg (lb)	L1 in mm (inch)	Weight in kg (lb)	L1 in mm (inch)	Weight in kg (lb)
JIS/ISO 2852 1"	25	HS9	280 (11)	5,2 (11)	320 (12.6)	7,2 (16)	–	–	–	–
JIS/ISO 2852 1½"	40		280 (11)	5,2 (11)	320 (12.6)	7,2 (16)	480 (18.9)	14 (31)	–	–
JIS/ISO 2852 2"	50		–	–	–	–	470 (18.5)	14 (31)	600 (23.6)	22.9 (50)
JIS/ISO 2852 2½"	65		–	–	–	–	–	–	580 (22.8)	22.8 (50)
JIS/ISO 2852 3"	80		–	–	–	–	–	–	580 (22.8)	22.9 (50)

Meaning of "–": not available

Typical dimensions of measuring tubes

Tab. 8: Typical dimensions of measuring tubes

Meter size	Material of wetted parts	Model code pos. 4	Internal diameter in mm (inch)	Wall thickness in mm (inch)
Hygienic 25	Stainless steel 1.4404/316L	S	5.60 (0.220)	0.45 (0.018)
Hygienic 40			9.00 (0.354)	0.50 (0.020)
Hygienic 50			17.10 (0.673)	0.95 (0.037)
Hygienic 80			27.60 (1.087)	1.70 (0.067)

2 Transmitter dimensions and weights

Transmitter dimensions

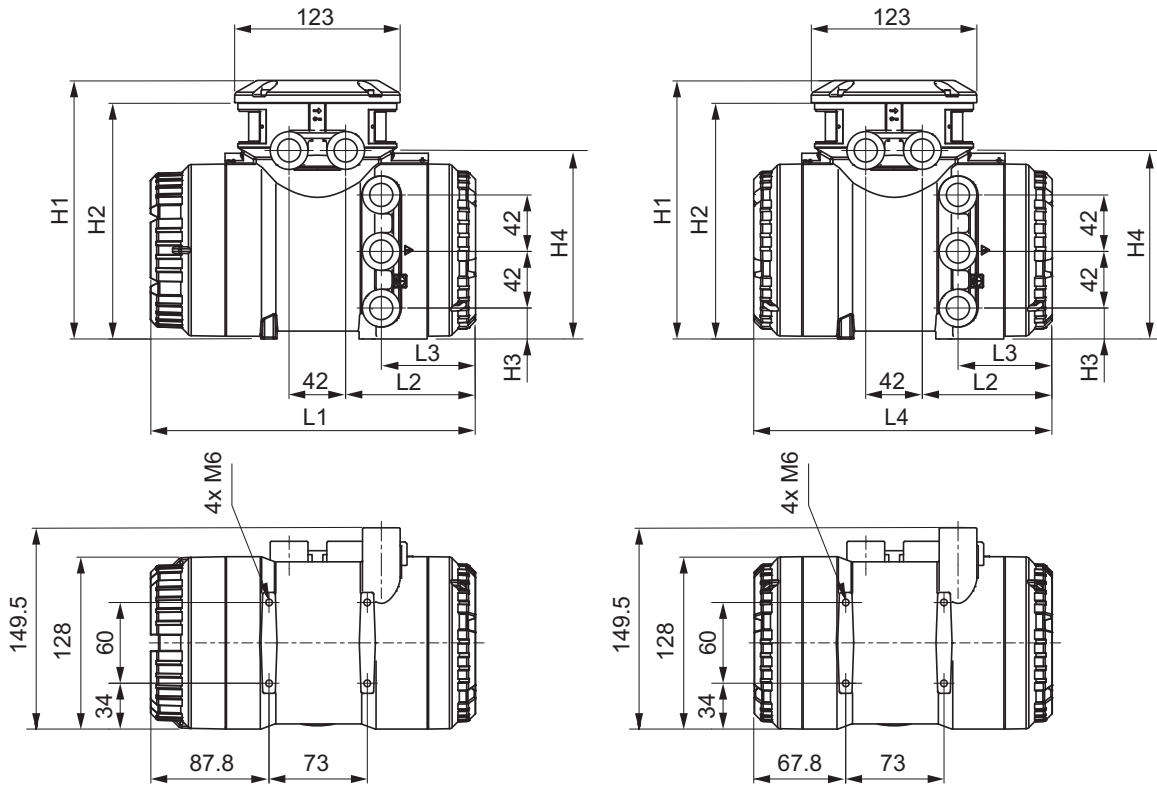
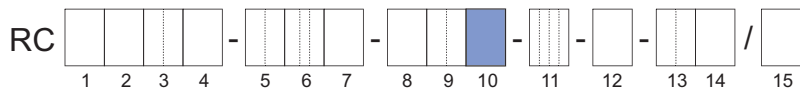
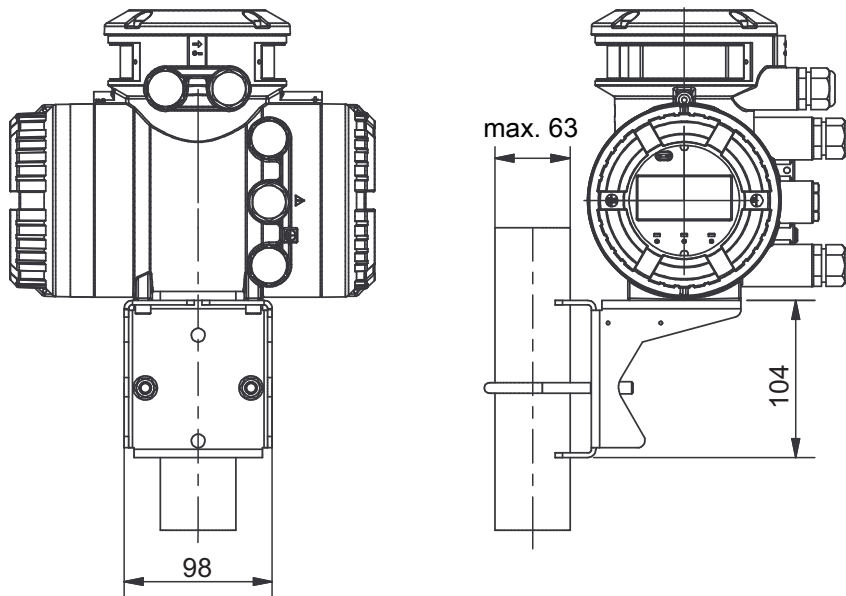

Fig. 2: Dimensions of transmitter in mm
(left: transmitter with display, right: transmitter without display)

Tab. 9: Overall length L1 - L4 and height H1 - H4 of transmitter (material: stainless steel, aluminum)

Material	L1 in mm (inch)	L2 in mm (inch)	L3 in mm (inch)	L4 in mm (inch)	H1 in mm (inch)	H2 in mm (inch)	H3 in mm (inch)	H4 in mm (inch)
Stainless steel	255.5 (10.06)	110.5 (4.35)	69 (2.72)	235 (9.25)	201 (7.91)	184 (7.24)	24 (0.94)	150.5 (5.93)
Aluminum	241.5 (9.51)	96.5 (3.8)	70 (2.76)	221 (8.7)	192 (7.56)	175 (6.89)	23 (0.91)	140 (5.51)



Transmitter weights

Model code (pos. 10)	Design type	Housing material of transmitter	Weight in kg (lb)
A, E	Remote	Aluminum	max. 4.4 (9.7)
J		Stainless steel	12.5 (27.6)

3 Wiring

3.1 Terminal configuration diagrams

3.1.1 Terminal for connection between sensor and transmitter

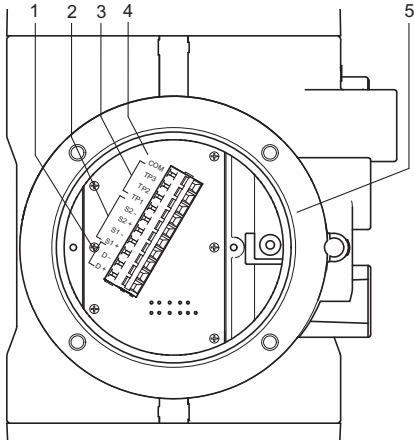

Fig. 3: Connection terminal circuits (transmitter on the left side, sensor on the right side)

- | | | | |
|---|---|---|------------------|
| 1 | Driver circuit (D+/D-) | 4 | Signal grounding |
| 2 | Sensor circuits (S1+/S1-, S2+/S2-) | 5 | Transmitter |
| 3 | Temperature measurement circuit (TP1, TP2, TP3) | 6 | Sensor |

3.1.2 Terminal for I/O outputs and power supply

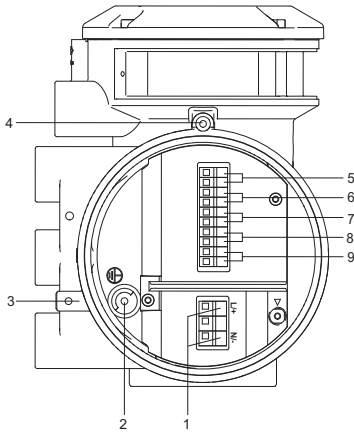

Fig. 4: Terminal for I/O outputs and power supply in transmitter

- | | | | |
|---|-----------------------------------|---|-----------------------------------|
| 1 | Power supply connection terminals | 6 | Connection terminals for I/O2 +/- |
| 2 | Grounding screw in terminal box | 7 | Connection terminals for I/O3 +/- |
| 3 | Grounding transmitter housing | 8 | Connection terminals for I/O4 +/- |
| 4 | Locking screw | 9 | WP: Write-protection terminal |
| 5 | Connection terminals for I/O1 +/- | | |

4 Connecting cable dimensions and weights

4.1 Standard cable (option /L_ without option /LAC)

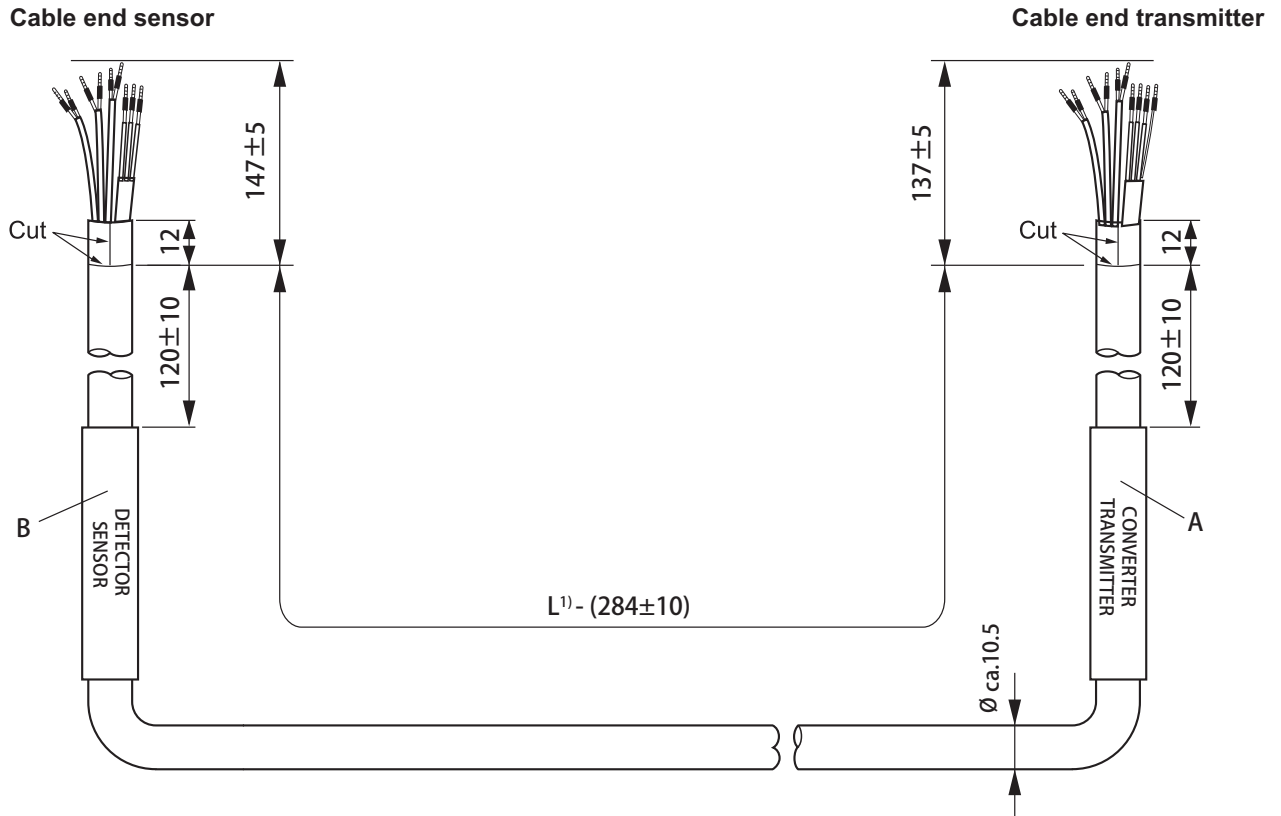

Fig. 5: Dimensions of standard cable (option /L_ without option /LAC), terminated in mm and labelling

Label number	Label name	Installation status
A	CONVERTER/TRANSMITTER	Factory labeled
B	DETECTOR/SENSOR	

¹⁾ L: Length of connecting cable

Options	Length of connecting cable in m (ft)	Colour of connecting cable
/L000	Without connecting cable	Non Ex: gray / Ex: blue
/L005	5 m (16.4 ft)	
/L010	10 m (32.8 ft)	
/L015	15 m (49.2 ft)	
/L020	20 m (65.6 ft)	
/L030	30 m (98.4 ft)	

- Weight of cable ≤ 0.200 kg/m (0.134 lb/ft)

A cable assembly kit is included for possible repairs.

4.2 Steel armored cable (option /L_ with option /LAC)

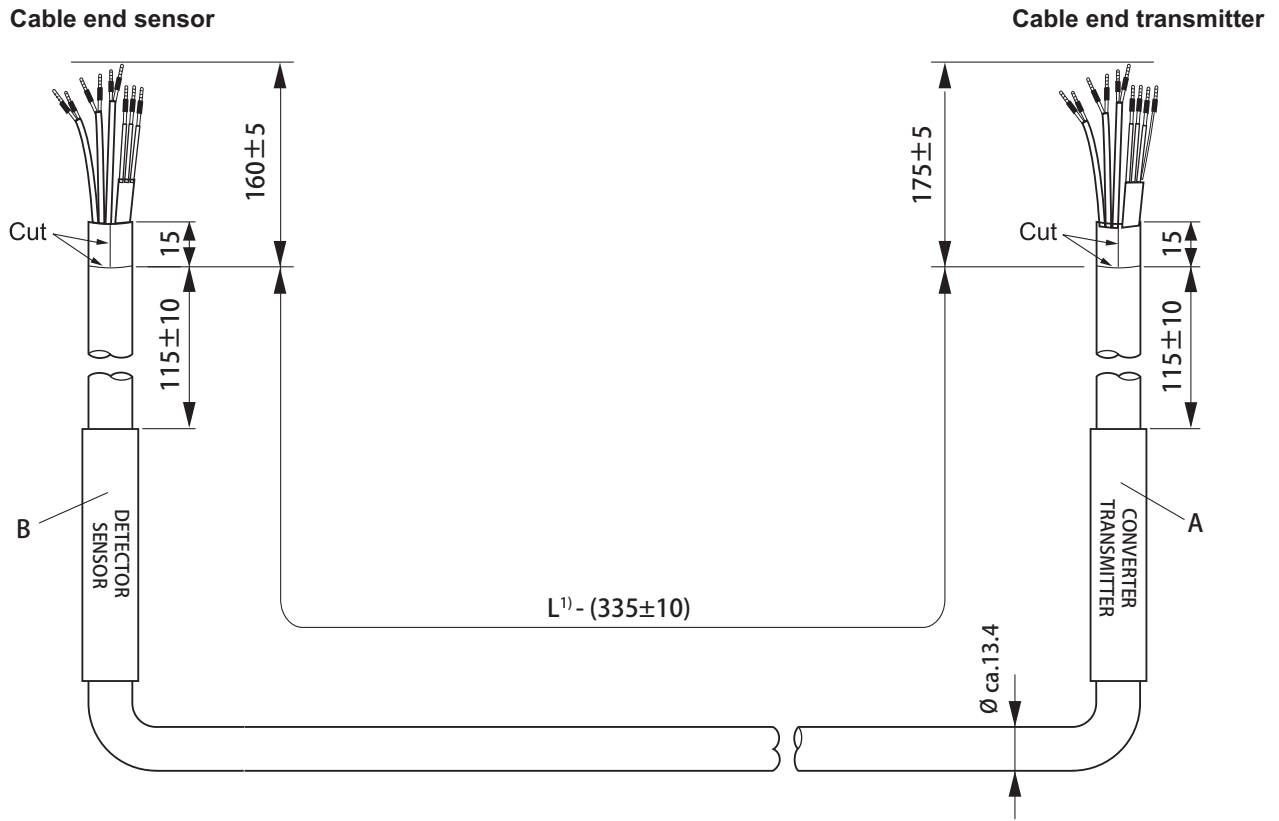

Fig. 6: Dimensions of standard cable (option /L_ with option /LAC), terminated in mm and labelling

Label number	Label name	Installation status
A	CONVERTER/TRANSMITTER	Factory labeled
B	DETECTOR/SENSOR	

¹) L: Length of connecting cable

Options	Length of connecting cable in m (ft)	Colour of connecting cable
/L005, /LAC	5 m (16.4 ft)	Blue
/L010, /LAC	10 m (32.8 ft)	
/L015, /LAC	15 m (49.2 ft)	
/L020, /LAC	20 m (65.6 ft)	
/L030, /LAC	30 m (98.4 ft)	

- Weight of cable ≤ 0.300 kg/m (0.202 lb/ft)

A cable assembly kit is included for possible repairs.

4.3 Fire retardant cable (option /Y_...)

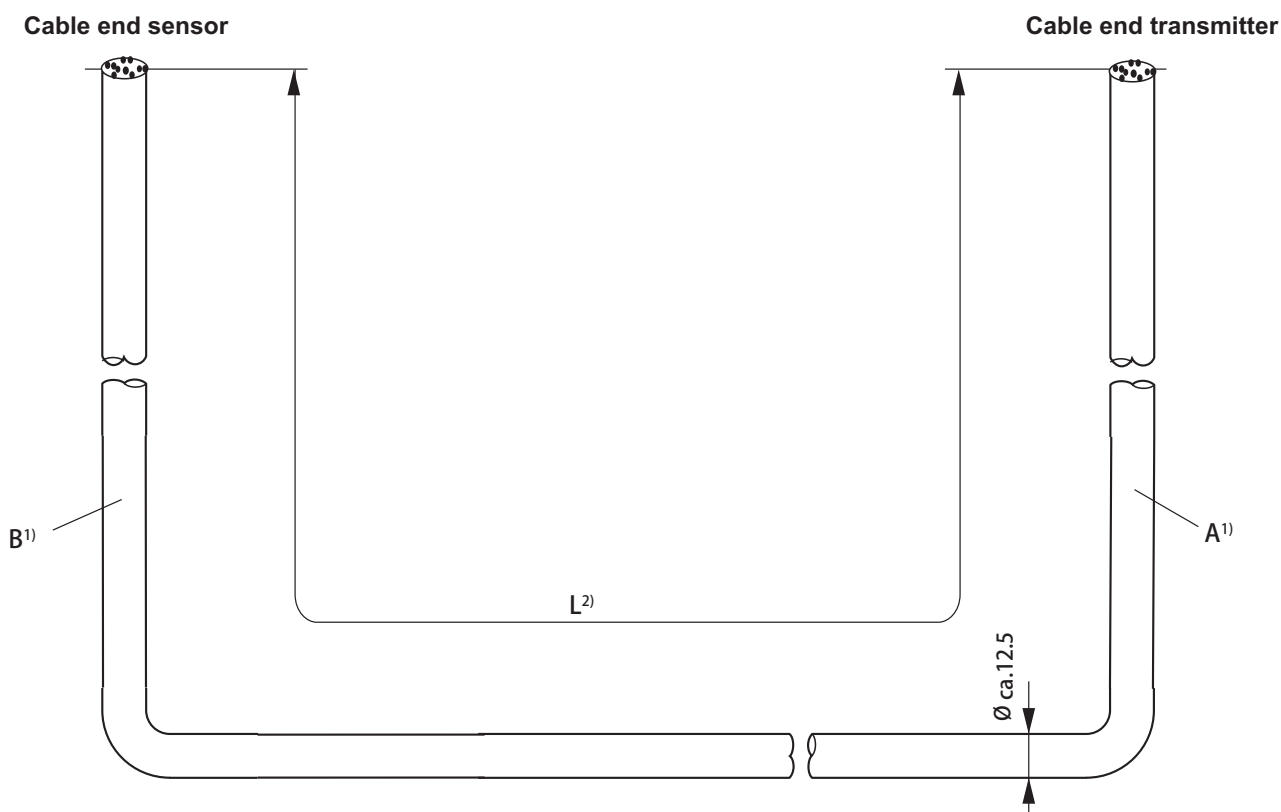

Fig. 7: Dimensions of fire retardant cable (option /Y_...), not terminated³⁾ in mm and labelling

Label number	Label name	Installation status
A	CONVERTER/TRANSMITTER	Separately enclosed
B	DETECTOR/SENSOR	

¹⁾ Installation of label A/B: Label A/B is included in termination kit. Install the label inside an appropriate cable area near the mounted cable gland.

²⁾ L: Length of connecting cable

³⁾ The cable can also be supplied pre-assembled.

Options	Length of connecting cable in m (ft)	Colour of connecting cable
/Y000	Without connecting cable	Gray
/Y005	5 m (16.4 ft)	
/Y010	10 m (32.8 ft)	
/Y015	15 m (49.2 ft)	
/Y020	20 m (65.6 ft)	
/Y030	30 m (98.4 ft)	

- Weight of cable ≤ 0.270 kg/m (0.181 lb/ft)

A cable assembly kit with instructions is included.

5 Japan Ex cable gland dimensions (option /V5_)

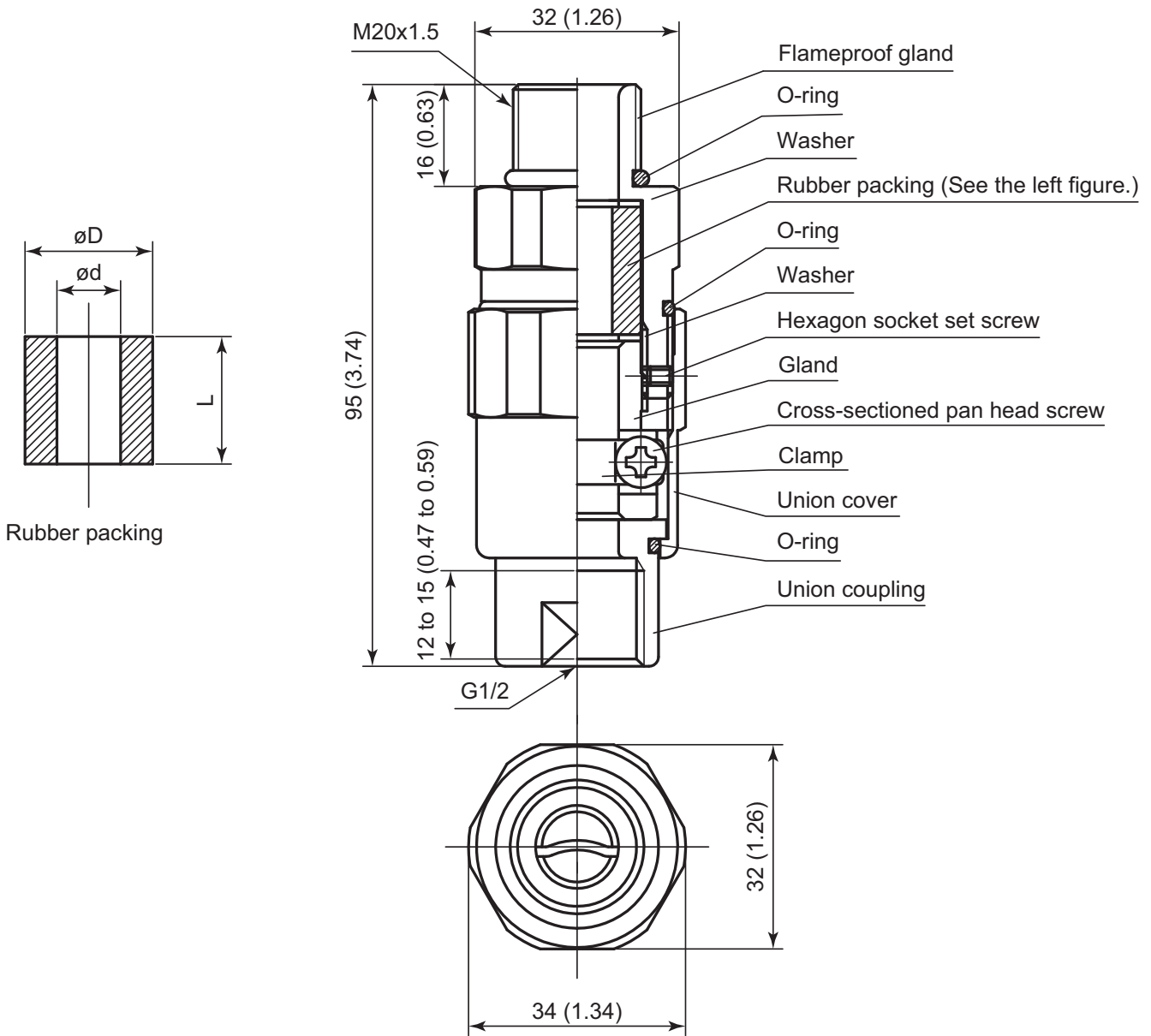

Fig. 8: Dimensions of cable gland (option V5_), in mm (inch)

Dimensions of rubber packing (before compression)			Identification mark of rubber packing	Cable outer diameter	
L	Ø D	Ø d		Min.	Max.
in mm (inch)					
20 (0.79)	Ø 20 (0.79)	Ø 10 (0.39)	Ø 10 (0.39)	Ø 8.0 (0.31)	Ø 10.0 (0.39)
20 (0.79)	Ø 20 (0.79)	Ø 12 (0.47)	Ø 12 (0.47)	Ø 10.0 (0.39)	Ø 12.0 (0.47)

(Blank page)

TRADEMARKS

ROTAMASS:	registered trademark of Rota Yokogawa GmbH & Co. KG, DE
TRI-CLAMP:	registered trademark of ALFA LAVAL CORPORATE AB, SE

All company and product names mentioned in this document are trade names, trademarks or registered trademarks of their respective companies. In this document, trademarks or registered trademarks are not marked with TM or ®.

All rights reserved. Copyright © 2026-05-20

Manufacturer:

Rota Yokogawa GmbH & Co. KG
Rheinstr. 8
D-79664 Wehr
Germany

For the actual manufacturing location of your device refer to the model code and/or serial number.

