

Drawings

Model GX70SM
Wireless Input Unit

SMARTDAC+

SD 04L57B01-01EN

Unit: mm [approx. inch]

GX70SM External Dimensions

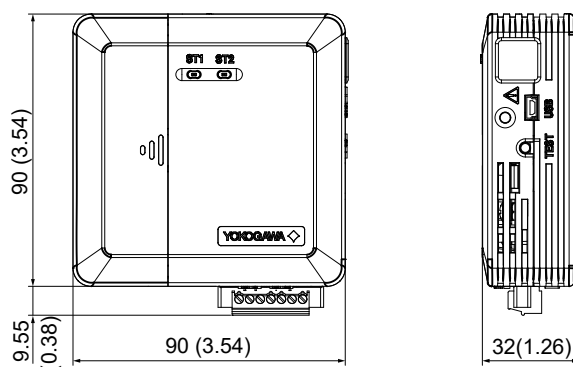

When using the sleeve antenna

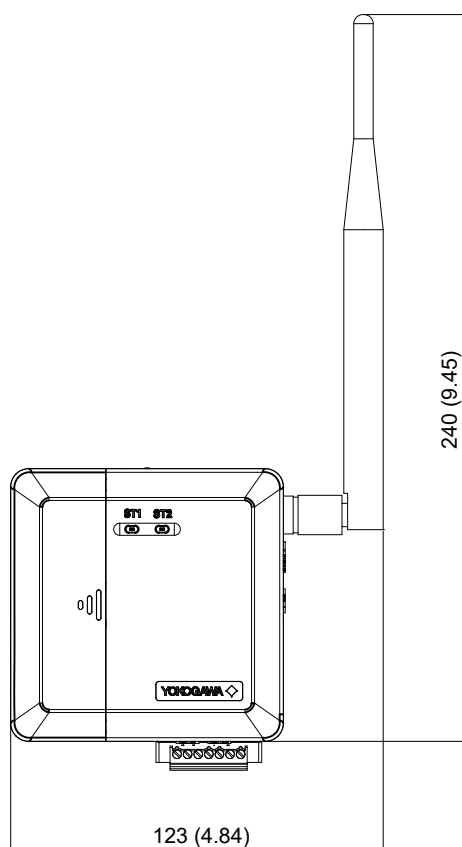

Unless otherwise specified, tolerance is $\pm 3\%$ (however, tolerance is ± 0.3 mm when below 10 mm).

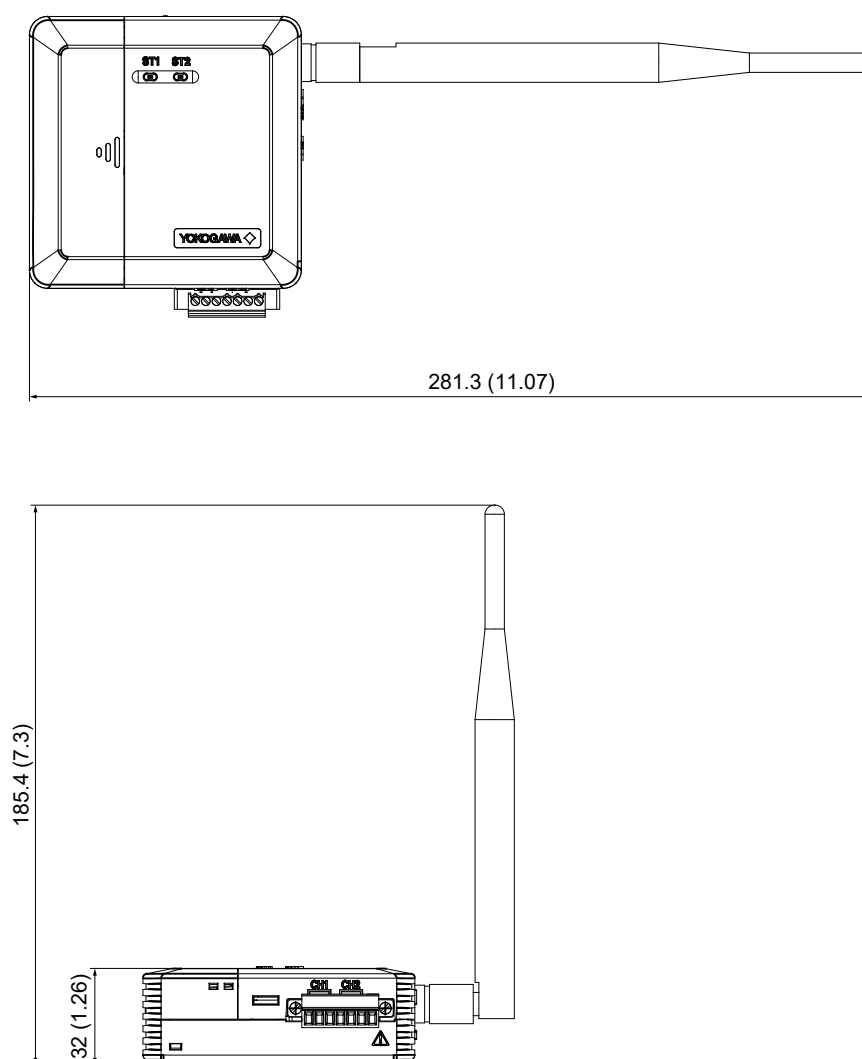
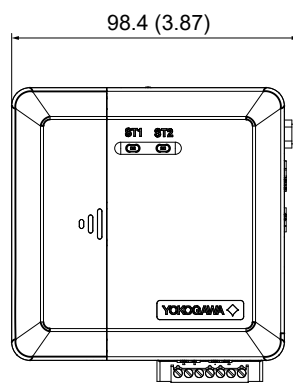
When using the sleeve antenna**When using the roof top antenna**

Unless otherwise specified, tolerance is $\pm 3\%$ (however, tolerance is ± 0.3 mm when below 10 mm).

Unit: mm [approx. inch]

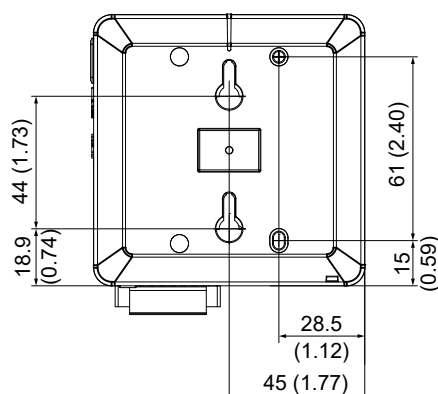
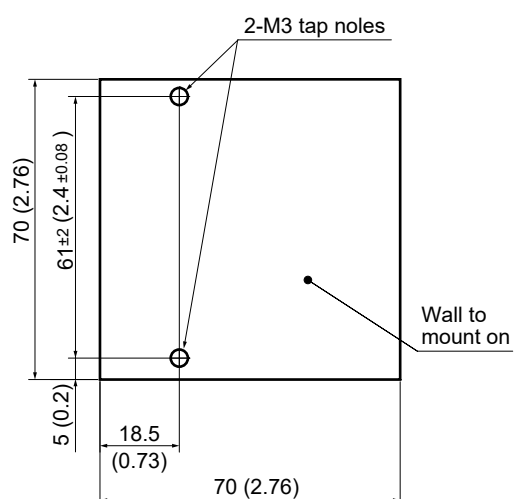
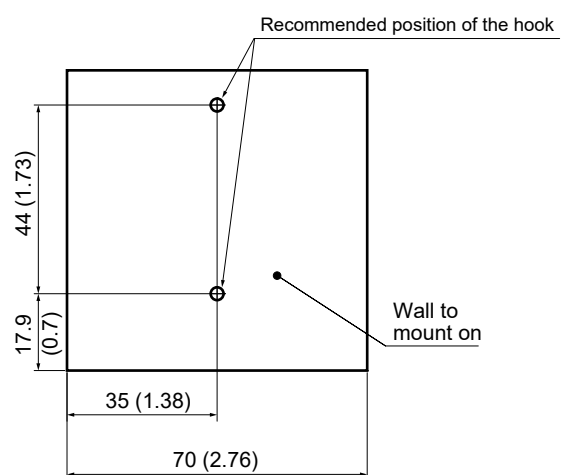
Rear view**Wall Mount Dimensions****Screw fixing****Hooked on a wall****Recommended screw for hooking**

- Round wood screw: Nominal diameter M3.5
- Length below the neck of the screw: 10 mm (0.39) or more
- Amount of screw showing from the wall surface to the screw head: 3.5 mm to 4.0 mm (0.14 to 0.16)

Unless otherwise specified, tolerance is $\pm 3\%$ (however, tolerance is ± 0.3 mm when below 10 mm).